

PREMIUM LIST

EVENT #s 2019004925
& 2019004926

(UNBENCHED)

TWO ALL-BREED DOG SHOWS

w/ TWO JUNIOR SHOWMANSHIP COMPETITIONS



(Licensed by the American Kennel Club)

**WEITENDORF AGRICULTURAL EDUCATIONAL
CENTER OF JOLIET JUNIOR COLLEGE**

17840 West Laraway Road, JOLIET, IL 60433

SATURDAY, OCTOBER 5, 2019

SUNDAY, OCTOBER 6, 2019

THESE SHOWS WILL BE HELD INDOORS

**THIS YEAR THERE IS ADDITIONAL GROOMING INSIDE
& ADDITIONAL ELECTRIC AT NO CHARGE**

SUPPORTED ENTRIES BOTH DAYS
Western Irish Setter Club, Inc.

NEW EXHIBITOR - BRIEFING NEED HELP, NEW EXHIBITOR, ANY EXHIBITOR
Please come to Superintendents Office between 8:30 - 10:30 AM each day.

There will be No Breed Classes offered for Poodles (Toy, Miniature & Standard), on Saturday. There will be No Breed or Junior Showmanship Classes offered for Keeshonden on Saturday & Sunday.

ENTRIES CLOSE AT THE SUPERINTENDENT'S OFFICE WEDNESDAY NOON (EDT), SEPTEMBER 18, 2019, AFTER WHICH TIME ENTRIES WILL NOT BE ACCEPTED, CANCELLED, ALTERED OR SUBSTITUTED, EXCEPT AS PROVIDED FOR IN CHAPTER 11, SECTION 6 OF THE DOG SHOW RULES.

THERE WILL BE NO OBEDIENCE OR RALLY OFFERED AT THESE SHOWS

"The Stone City Kennel Club does not agree to arbitrate claims as set forth on the official AKC Entry Form for this event."

Special Attractions:

SATURDAY, OCTOBER 5, 2019 & SUNDAY, OCTOBER 6, 2019

Huge 2- DAY Raffle - Stone City Kennel Club

Consession Stand Available For Breakfast & Lunch

During Groups & Best In Show

Refreshments will be served provided by Stone City Kennel Club

SHOW HOUR EACH DAY 6:00 A.M. to 7:00 P.M. - CDT

Dogs need not be present until scheduled time of judging and may leave immediately thereafter, unless required for further judging.

SHOW LOCATION IS AVAILABLE TO EXHIBITORS FRIDAY, OCTOBER 4, 2019, AT 5:00 P.M.

ENTRY FEES FOR EACH DAY & FOR EACH EVENT

NOTE: ENTRY FEES MUST BE RECEIVED FOR EACH ENTRY FOR EACH EVENT EACH DAY! IF FEES ARE RECEIVED FOR ONLY ONE EVENT, ONLY THE FIRST EVENT WILL BE PROCESSED.

ENTRY FEE is \$28.00 for the first entry of each dog for each event, except for Puppy Classes & Bred-by-Exhibitor which are \$24.00 for each event. Each Additional Entry of the same dog is \$10.00 for each event. JUNIOR SHOWMANSHIP is \$24.00 for each event if entered for 'Junior Showmanship Only' or if an Additional Entry; \$10.00 for each event. Fees include the 50¢ AKC Recording Fee and the \$3.00 AKC Event Service Fee on the first entry of a dog and a \$3.00 AKC Event Service Fee for each additional entry of the same dog in the regular and non-regular recordable single entry classes. (There is no recording fee or event service fee for junior showmanship, sweepstakes, futurities, brace/team, multi-dog classes, or special attractions.)

ENTRIES CLOSE at Superintendent's Office, **WEDNESDAY NOON (EDT), SEPTEMBER 18, 2019**, after which time entries will not be accepted, cancelled, altered or substituted, except as provided for in Chapter 11, Section 6 of the Dog Show Rules.

When a dog is entered in more than one class, the highest priced class is considered the first entry. MAKE CHECKS and Money Orders payable to Roy Jones Dog Shows, Inc. (Returned Check Charge \$40.00). All Checks Must Have Show(s) & Breed(s) entered written on the face. **THIRD PARTY CHECKS WILL NOT BE ACCEPTED!**

ALL ENTRIES MUST BE SUBMITTED ON OFFICIAL AKC ENTRY FORMS, one dog per entry form. Photocopies of front & back will be accepted only if legible, and official AKC size.

MAIL ENTRIES with Fees to Superintendent, **ROY JONES DOG SHOWS, INC., P.O. BOX 828, AUBURN, IN 46706.**

ENTRIES WILL NOT BE ACCEPTED WITHOUT SIGNATURE, FEES AND BACK ON ENTRY FORM WITH AGREEMENT, NOR WILL CREDIT CARDS BE ACCEPTED FOR MAIL-IN ENTRIES.

ALL ENTRIES MUST BE SUBMITTED with checks drawn on U.S. Institutions or with International Money Orders in U.S. Funds.

EXHIBITORS PLEASE NOTE

Exhibitors should follow their Veterinarians' recommendation to assure their dogs are free of internal and external parasites, any communicable diseases, and have appropriate vaccinations.

No dogs that are disqualified for aggression will be allowed to enter these Shows, nor be allowed to be on the grounds. In addition, no aggression reinstatement procedures will be performed at these Shows.

"Dogs found in an unsafe environment, distress or harm's way (for example: left unattended on a grooming table in a noose not attached to a safety release clip; left in a vehicle without proper ventilation) will be removed to safety. Exposing a dog to an unsafe environment, distress or harm's way is considered mistreatment."

ATTENTION OWNERS/EXHIBITORS OF FOREIGN REGISTERED DOGS

If you are the owner/exhibitor of a dog registered with a foreign registry (not yet dual registered with AKC) please review the eligibility requirements in The Rules Applying to Dog Shows, chapter 11 section 1. The dog show rules are posted on the AKC Web site at <http://images.akc.org/pdf/rulebooks/RREGS3.pdf>.



**AMERICAN
KENNEL CLUB®**

CERTIFICATION Permission has been granted by the American Kennel Club for the holding of this event under the American Kennel Club rules and regulations.

GINA M. DINARDO, Executive Secretary

American Kennel Club Annually Licensed Superintendent's

VIRGINIA W. SLEEPER DALE D. NEUKOM, JR.

JEFFERY W. INMAN EVAN C. BRUDI CYNTHIA J. POOLE

One or more of the above superintendents will superintend this show.

SERVICES AND EQUIPMENT FURNISHED BY



Post Office Box 828 Auburn, IN 46706
Phone (260) 925-0525 • Fax (260) 925-1146
www.royjonesdogshows.com

* ATTENTION * Online entries through our website!!!

OFFICERS

PRESIDENTDr. Lee Cera
VICE PRESIDENTLorraine Bartlett
TREASURER Julie Glenn
RECORDING SECRETARY Nicole Bailey
CORRESPONDING SECRETARY Alyssa Battaglia-Hofman
761 Columbia Dr., New Lennox, IL 60451 • AlyssaM.battaglia@gmail.com

BOARD OF DIRECTORS

Patti Volz Elice DeRoos Donna DeRess Mary Ann Condit

SHOW COMMITTEE

Mary Ann Condit, Show Chairperson, 205 Tiverton, Kankakee, IL 60901
815-954-1145

And All Officers and Members of the Board

TROPHIESMary Ann Condit
CHIEF RING STEWARD Julie Glenn
CATALOG ADVERTISINGMary Ann Condit
PUBLICITY Elice DeRoos
SHOW HOSPITALITYDonna DeRess

The Stone City Kennel Club retains all rights to photograph or videotape by any means, and televise or reproduce this event in any way, now and in the future.

The Show Chair will not exhibit a dog at this Show, nor own nor co-own an entry at this Show.

VETERINARIAN (Will be on Call Both Days)

Midwest Animal Hospital, 11205 183rd Place, Orland Park, IL 60467 • 708-478-7788

DIRECTIONS TO EMERGENCY VET: Animal Emergency of Mokena, 19110 South 88th Avenue, Mokena, IL 60448 • 708-326-4800. Take I-80 East to Route 45 South (LaGrange Road) at First Stop Light (191st Street) take a Left, go East. Clinic is on the corner of 88th Avenue & 191st Street. Next to Prairie Bank.

PHOTOGRAPHER

Skibinski Photography, Robert J. Skibinski, 10766 Hanley Street, Crown Point, IN 46307
219-662-7725 • skibinski2@aol.com • www.skibinskiphoto.com

(Only the Official Photographer may take win photos in the ring or at their backdrop.)

PUBLICATION RIGHTS By entering this show, all owners, handlers, breeders and kennels agree that all rights to televise, videotape, photograph, advertise, promote and publicize or otherwise exploit this show, or the persons or animals participating in it or the results of the competition before, during or after the event, shall belong solely to The American Kennel Club and their respective assigns, including the use of the names, likenesses or biographical matter of all dogs, owners, handlers, breeders and kennels participating in the show and no such owner, handler, breeder or kennel shall allow any other party to make commercial use of any videotape or photograph of any person or animal participating in this competition.

EXHIBITORS PLEASE NOTE

Stone City Kennel Club Welcomes you to Our New Show Site. Please keep this Show Facility as clean as possible - This is a SELF Cleaning Show Site - You are responsible for cleaning up after your own dog.

Security Guard 24 hours/day dogs may be left in building in secure crates during overnight. Doors in building will be locked at 10:00 P.M. Friday & Saturday and re-open Saturday & Sunday at 6:00 A.M. (Guards inside & security cameras).

ATTENTION EXHIBITORS

- Daily Parking fee \$6.00 per day or \$10.00 for a 2 Day Pass - payable at gate.
• No admission fee.
• Adjacent camping area no hook-ups!
• No exercise pens or crate set up indoors. Grooming indoors in specified area only.
• ALL EXERCISE PENS ARE NOT ALLOWED IN BUILDINGS.
• No Soft Sided Crates or flexi-leads.
• Show Site including Building Access, Parking and Restrooms meet all handicapped accessibility requirements.
• NO Grooming under Pavilion. All Grooming indoors.
• Please turn off cell phones and/or pagers before entering rings.
• Only dogs that are AKC eligible are allowed on the show grounds.
• No Dogs allowed on grass surrounding buildings.
• No Dogs allowed in any Ponds on property.

VENDORS & CATALOG ADVERTISING

Contact Mary Ann Condit, 205 Tiverton, Kankakee, IL 60901
815-954-1145

Several indoor & outdoor spaces available. First come first served.
10"x10" Spaces. \$50.00 for 2 days. (Electric is free)
Payable in advance. No cancellation after September 12, 2019
\$35.00 per page for a Full Page Ad.
ONLY COVER PAGES can be printed in Color at \$10.00 extra for camera ready \$45.00.

STONE CITY KENNEL CLUB

is proud to offer the following to all dog owners at our All Breed show on SUNDAY, October 6th:

HEART BY CARDIOLOGIST:

The heart auscultations are \$45 per dog and are performed by Dr Alyssa Pinkos, DVM, DACVIM. Please do not print out the form from OFA - there are special forms now that we will have at the clinic.

EYE BY OPHTHALMOLOGIST:

The eye examinations are \$40 per dog and are performed by Dr Adam King, DVM, MS, DACVO

THYROID BY MICHIGAN STATE UNIVERSITY:

This will be done by blood draw and submitted by us to MSU. The cost is \$85 per dog - BEST PRICE EVER!

BAER - BRAINSTEM AUDITORY EVOKED RESPONSE:

The BAER exam is \$85 and will be performed by Dr Joann Randall, DVM, DACT. NOTE: We need a minimum of 20 dogs in order to offer this test.

MICROCHIP - AKC REUNITE:

We will be implanting microchips with prepaid registrations from AKC Reunite. The cost is \$30.

PAW PRINT GENETICS DISEASE TESTING:

for our clinic, we have obtained special pricing with Paw Print Genetics. Any test that is offered on Pawprintgenetics.com is at a 30% discount. If you do 3 or more tests on one dog, your savings increases to 50%. Tests are normally \$80 each. At our clinic, each test is only \$56 (on multiple dogs). If you test one dog for 3 diseases, the cost becomes \$37.50 per test (Total \$112.50). The savings accumulates the more tests you do. (Ask me for the pricing breakdowns). We will collect the DNA ourselves (\$5 convenience fee per dog) and ship it to Paw Print Genetics - much less for you to think about!

OFA CLINIC DISCOUNT:

All OFA submissions will have a 50% discount over the regular submission price. Please print out your OFA forms (except HEART) for the all testing you're going to submit to OFA, so that we can apply the sticker.

WHERE:

The testing will be done at the Weitendorf Agricultural Education Center at 17840 W Laraway Rd, Joliet IL 60433 from 9am until 3 pm. Please follow the signs to the health clinic.

ENTRIES:

Please send your pre-entry to Heidi McClure, PO Box 9305, Aurora, IL 60598. Call or text questions to 847.630.1943 or hmcclure@earthlink.net CHECKS ARE MADE PAYABLE TO STONE CITY KENNEL CLUB. Pre-entries close on Sept 25th. All entries must be postmarked by that date. A schedule will be emailed and posted on sckc.us by Sept 28th.

NOTES:

Entries will be taken on Sunday on a first come, first serve basis. The first six section's cost will increase by \$5 each, day of clinic. Parking is \$6 for the day or \$10 for the weekend. Clinic is open to the public.

Your name _____ Phone _____ Cell or Home? _____

Address _____ Showing? YES NO

CITY/STATE/ZIP _____ Email _____

Dog #1 _____ DOB _____ AKC# _____

Dog #2 _____ DOB _____ AKC# _____

Dog #3 _____ DOB _____ AKC# _____

Dog #4 _____ DOB _____ AKC# _____

Dog #5 _____ DOB _____ AKC# _____

If you are showing, we will do our best to schedule around your showing times and to schedule eyes after your ringtime.

ROUTESTOSHOW

From the North: I-294 South to I-80 West. I-80 West to Briggs Street South to Laraway Road. Turn Right (West) to Weitendorf Agricultural Center, North side of Laraway (Right Turn).
From the South: I-55 to I-80 East to Route 53 South to Laraway Road. Turn Left (East) to Weitendorf Agricultural Center.
From the East: I-80 West to Briggs Street South to Laraway Road. Turn Right (West) to Weitendorf Agricultural Center.
From the West: I-80 East to Route 53 South to Laraway Road. Turn Left (East) to Weitendorf Agricultural Center.

Weitendorf Agricultural Education Center of Joliet Junior College
Address: 17840 W Laraway Road, Joliet, IL 60433 Phone: 815-280-6900
Website: <http://www.jjc.edu/Pages/default.aspx> Located at: Weitendorf John H RI Est

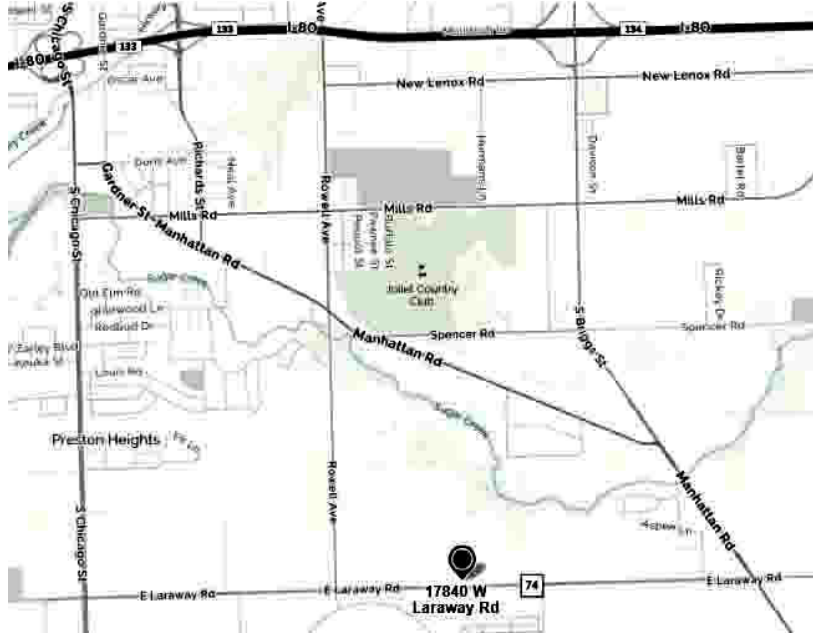

ACCOMMODATIONS

PLEASE CHECK WITH EACH HOTEL REGARDING THEIR CURRENT PET POLICY

- Hotel policies may change toward dogs, please verify current policies when making reservations.**
- COMFORT INN, 1520 Commerce Lane, Joliet, IL 60436 (Fee for Pets) 815-730-1111
 - FAIRFIELD INN, 1501 Riverboat Center, Joliet, IL 60436 (Fee for Pets) 815-741-3499
 - TOWNPLACE SUITES BY MARRIOTT, 1515 Riverboat Center, Joliet, IL 60436 (Fee for Pets) .. 815-741-2400
 - RED ROOF INN, 1750 McDonough Street, Joliet, IL 60436 (No additional charge for dog) 815-741-2304

CAMPSITES

- HOLLYWOOD CASINO 888-436-7737
 777 Hollywood Blvd., Joliet, IL 60436 (Dogs welcome in campground)
 Over 80 Full Hook-ups - Hot Breakfast free with Night Stay
- MARTIN CAMPGROUND 815-726-3173
 725 Cherry Hill Road, Joliet, IL 60433 (Full Hook-ups - Pets welcome)

SATURDAY, OCTOBER 5, 2019 - SAME LOCATION
INDEPENDENT SPECIALTY LIMIT 50 ENTRIES
ONE HALF HOUR FOLLOWING BEST IN SHOW
WESTERN IRISH SETTER CLUB, INC.

Show Secretary-Elizabeth Ford, c/o Roy Jones Dog Shows, Inc., PO Box 828, Auburn, IN 46706
 260-925-0525 FAX 260-925-1146 • ENTRIES CLOSE Sept. 18, 2019

RV PARKING INFORMATION
RESERVATION ONLY

- Available on a first come first served basis.
- Please make your reservation early.
- VERY LIMITED RV Parking.
- Generators are allowed outside of buildings only.
- No Hook-ups (No electric, water or sewer).
- Sites will measure approximately 20' x 45'.
- Only RV & one (1) Registered tow vehicle per site.
- Friday, October 4, 2019 after 5:00 P.M. sites will be available.
- Sunday, October 6, 2019 all vehicles must leave property by 6:00 P.M.
- 1 Night Parking fee is \$25.00 (**MUST CALL PATTY VOLZ IF REQUESTING ONE NIGHT 815-469-3001**)
- 2 Night Parking fee (Friday, October 4 & Saturday, October 5, 2019) is \$50.00 must be paid by September 19, 2019.

Make all Checks Payable to Stone City Kennel Club
 C/O Patty Volz
 23752 S 104th Avenue
 Frankfort, IL 60423 Phone 815-469-3001

Name: _____

Address: _____

Phone including area code _____

Type of Vehicle _____ Overall "Rig" size _____

Vehicle License # & State _____

Towed Vehicle License # & State _____

NO HANDICAPPED SITES ARE AVAILABLE

Amount Enclosed: _____

One Night @ \$25.00

Both Nights @ \$50.00

Call if requesting one night - Patty Volz • 815-469-3001

THE RIBBON PRIZES WILL BE AS FOLLOWS:

REGULAR CLASSES		Best in Show Red, White & Blue Rosette	
First Prize	Blue Ribbon	Reserve Best in Show Yellow & White Rosette	
Second Prize	Red Ribbon	MISCELLANEOUS & JUNIOR SHOWMANSHIP CLASSES	
Third Prize	Yellow Ribbon	First Prize	Rose Ribbon
Fourth Prize	White Ribbon	Second Prize	Brown Ribbon
Winners	Purple Ribbon	Third Prize	Light Green Ribbon
Reserve Winners	Purple & White Ribbon	Fourth Prize	Gray Ribbon
Best of Winners	Blue & White Ribbon	Best of Breed	Orange Ribbon
Best of Breed & Best of Variety of Breed	Purple & Gold Ribbon	Best of Opposite	Lavender Ribbon
Best of Opposite Sex to Best of Breed & Variety of Breed	Red & White Ribbon	Best in Miscellaneous	Pink & Green Ribbon
Select	Light Blue & White Ribbon	Best Junior Handler	Rose & Green Rosette
		Reserve Best Junior Handler ..	Rose & Gray Rosette

CLASSIFICATION Classes for All Breeds and Varieties • Regular Classes

Puppy Dogs, 6 mos. & under 9 mos.	Puppy Bitches, 6 mos. & under 9 mos.
Puppy Dogs, 9 mos. & under 12 mos.	Puppy Bitches, 9 mos. & under 12 mos.
12 mos. & under 18 mos., Dogs	12 mos. & under 18 mos., Bitches
Novice, Dogs	Novice, Bitches
Bred-by-Exhibitor, Dogs	Bred-by-Exhibitor, Bitches
American-bred, Dogs	American-bred, Bitches
Open, Dogs	Open, Bitches
Winners, Dog	Winners, Bitch

Note: Amateur-Owner-Handler Classes are not offered

The above classes are provided in all Breeds and in each Breed Variety. Where certain classes are divided by color, or weight, it is so noted in List of Breeds, and MUST be indicated on entry form.

BEST OF BREED (VARIETY) COMPETITION

JUNIOR SHOWMANSHIP COMPETITION

NOVICE JUNIOR CLASS	NOVICE INTERMEDIATE CLASS	NOVICE SENIOR CLASS
OPEN JUNIOR CLASS	OPEN INTERMEDIATE CLASS	OPEN SENIOR CLASS
	MASTER CLASS	

NOTE: AKC Junior Handler Numbers are required for entry in Junior Showmanship Competition. Numbers may be obtained from the American Kennel Club - PHONE: 919-233-9767.

LIST OF JUDGES FOR ONE OR BOTH DAYS

- Mrs. Barbara L. Burns, 710 E Garden St, Freeport, IL 61032-5723
 Mr. Roger R. Hartinger, 3548 Centurion Dr, Cincinnati, OH 45211-1800
 Mrs. Paula Hartinger, 3548 Centurion Dr, Cincinnati, OH 45211-1800
 Mr. Ken J. Murray, 4403 Roberts Road, Island Lake, IL 60042-8517
 Mrs. Judy English Murray, 17581 2B Road, Walkerton, IN 46574-9223
 Mr. Jay Richardson, 38W024 Heatherfield Dr, Elgin, IL 60124-8800
 Mrs. Carol Steiner, 222 E Joliet Hwy, New Lenox, IL 60451-1862

* Indicates Provisional Judge

VARIETY GROUP JUDGES SATURDAY, OCTOBER 5, 2019

SPORTING	Mrs. Barbara L. Burns
HOUND	Mr. Ken J. Murray
WORKING	Mr. Ken J. Murray
TERRIER	Mr. Ken J. Murray*
TOY	Mrs. Paula Hartinger
NON-SPORTING	Mrs. Paula Hartinger
HERDING	Mrs. Paula Hartinger
BEST IN SHOW	Mr. Roger R. Hartinger

VARIETY GROUP JUDGES SUNDAY, OCTOBER 6, 2019

SPORTING	Mr. Jay Richardson
HOUND	Mrs. Paula Hartinger
WORKING	Mr. Jay Richardson
TERRIER	Mr. Jay Richardson
TOY	Mr. Roger R. Hartinger
NON-SPORTING	Mrs. Judy English Murray
HERDING	Mr. Roger R. Hartinger
BEST IN SHOW	Mr. Ken J. Murray

BREED LIST

SPORTING BREEDS	SATURDAY	SUNDAY
Brittany	Mrs. Paula Hartinger	Mr. Ken J. Murray
Lagotti Romagnoli	Mrs. Paula Hartinger	Mr. Ken J. Murray
Nederlandse Kooikerhondjes	Mrs. Paula Hartinger	Mr. Ken J. Murray
Pointers	Mrs. Paula Hartinger	Mr. Jay Richardson
Pointers (German Shorthaired)	Mrs. Paula Hartinger	Mr. Jay Richardson
Pointers (German Wirehaired)	Mrs. Paula Hartinger	Mr. Ken J. Murray
Retrievers (Chesapeake Bay)	Mrs. Paula Hartinger	Mr. Ken J. Murray
Retrievers (Curly Coated)	Mrs. Paula Hartinger	Mr. Ken J. Murray
Retrievers (Flat Coated)	Mrs. Paula Hartinger	Mr. Ken J. Murray
Retrievers (Golden)	Mrs. Paula Hartinger	Mr. Ken J. Murray
Retrievers (Labrador)	Mrs. Paula Hartinger	Mr. Ken J. Murray
Open classes divided: Black; Chocolate; Yellow		
Retrievers (Nova Scotia Duck Tolling)	Mrs. Paula Hartinger	Mr. Ken J. Murray
Setters (English)	Mrs. Paula Hartinger	Mr. Ken J. Murray
Setters (Gordon)	Mrs. Paula Hartinger	Mr. Ken J. Murray
Setters (Irish)	Mrs. Paula Hartinger	Mr. Roger R. Hartinger
Setters (Irish Red & White)	Mrs. Paula Hartinger	Mr. Ken J. Murray
Spaniels (American Water)	Mrs. Paula Hartinger	Mr. Ken J. Murray
Spaniels (Boykin)	Mrs. Paula Hartinger	Mr. Ken J. Murray
Spaniels (Clumber)	Mrs. Paula Hartinger	Mr. Ken J. Murray
Spaniels (Cocker) Black	Mrs. Paula Hartinger	Mr. Jay Richardson
Spaniels (Cocker) ASCOB	Mrs. Paula Hartinger	Mr. Jay Richardson
Spaniels (Cocker) Parti-Color	Mrs. Paula Hartinger	Mr. Jay Richardson
Spaniels (English Cocker)	Mrs. Paula Hartinger	Mr. Jay Richardson
Spaniels (English Springer)	Mrs. Paula Hartinger	Mr. Ken J. Murray
Spaniels (Field)	Mrs. Paula Hartinger	Mr. Ken J. Murray
Spaniels (Irish Water)	Mrs. Paula Hartinger	Mr. Ken J. Murray
Spaniels (Sussex)	Mrs. Paula Hartinger	Mr. Ken J. Murray
Spaniels (Welsh Springer)	Mrs. Paula Hartinger	Mr. Ken J. Murray
Spinoni Italiani	Mrs. Paula Hartinger	Mr. Ken J. Murray
Vizslas	Mrs. Paula Hartinger	Mr. Ken J. Murray
Weimaraners	Mrs. Paula Hartinger	Mr. Ken J. Murray
Wirehaired Pointing Griffons	Mrs. Paula Hartinger	Mr. Ken J. Murray
Wirehaired Vizsla	Mrs. Paula Hartinger	Mr. Ken J. Murray

HOUND BREEDS

SATURDAY	SUNDAY
Afghan Hounds	Mrs. Barbara L. Burns*
American English Coonhounds	Mr. Roger R. Hartinger
American Foxhounds	Mr. Ken J. Murray
Azawakhs	Mr. Ken J. Murray
Basenjis	Mr. Ken J. Murray
Basset Hounds	Mr. Ken J. Murray
Beagles (13 Inches)	Mr. Ken J. Murray
Beagles (15 Inches)	Mr. Ken J. Murray
Black & Tan Coonhounds	Mr. Ken J. Murray
Bloodhounds	Mr. Ken J. Murray
Bluetick Coonhounds	Mr. Ken J. Murray
Borzoi	Mr. Ken J. Murray
Cirneco dell'Etna	Mr. Ken J. Murray
Dachshunds (Longhaired)	Mrs. Barbara L. Burns
Open classes divided: same as in Smooth Variety	
Dachshunds (Smooth)	Mrs. Barbara L. Burns
Open classes divided: Miniature-for dogs & bitches 11 lbs and under at 12 mos of age and older. Standard-for dogs & bitches over 11 lbs and under 11 lbs if less than 12 mos of age.	
Dachshunds (Wirehaired)	Mrs. Barbara L. Burns
Open classes divided: same as in Smooth Variety	
English Foxhounds	Mr. Ken J. Murray
Grand Basset Griffon Vendeen	Mr. Ken J. Murray
Greyhounds	Mr. Ken J. Murray
Harriers	Mr. Ken J. Murray
Ibizan Hounds	Mrs. Barbara L. Burns
Irish Wolfhounds	Mr. Ken J. Murray

Mail Early-Entries Close Wednesday Noon (EDT), September 18, 2019 9

Norwegian Elkhounds	Mr. Ken J. Murray	Mr. Jay Richardson
Otterhounds	Mr. Ken J. Murray	Mr. Roger R. Hartinger
Petit Basset Griffon Vendeens	Mr. Ken J. Murray	Mr. Roger R. Hartinger
Pharaoh Hounds	Mr. Ken J. Murray	Mr. Roger R. Hartinger
Plotts	Mr. Ken J. Murray	Mr. Roger R. Hartinger
Portuguese Podengo Pequeno	Mr. Ken J. Murray	Mr. Roger R. Hartinger
Open classes divided: Smooth Coat; Wire Coat		
Redbone Coonhounds	Mr. Ken J. Murray	Mr. Roger R. Hartinger
Rhodesian Ridgebacks	Mr. Ken J. Murray	Mr. Jay Richardson
Salukis	Mr. Ken J. Murray	Mr. Roger R. Hartinger
Scottish Deerhounds	Mr. Ken J. Murray	Mr. Roger R. Hartinger
Sloughis	Mrs. Barbara L. Burns*	Mr. Roger R. Hartinger
Treering Walker Coonhounds	Mr. Ken J. Murray	Mr. Roger R. Hartinger
Whippets	Mr. Ken J. Murray	Mr. Roger R. Hartinger

WORKING BREEDS SATURDAY SUNDAY

Akitas	Mr. Ken J. Murray	Mr. Jay Richardson
Alaskan Malamutes	Mr. Ken J. Murray	Mr. Jay Richardson
Anatolian Shepherd Dogs	Mr. Ken J. Murray	Mr. Jay Richardson
Bernese Mountain Dogs	Mr. Ken J. Murray	Mr. Jay Richardson
Black Russian Terriers	Mr. Ken J. Murray	Mr. Jay Richardson
Boerboels	Mr. Ken J. Murray	Mr. Jay Richardson
Boxers	Mr. Ken J. Murray	Mr. Jay Richardson

Open classes divided: Brindle; Fawn

Bullmastiffs	Mr. Ken J. Murray	Mr. Jay Richardson
Cane Corso	Mr. Ken J. Murray	Mr. Jay Richardson
Chinook	Mr. Ken J. Murray	Mr. Jay Richardson
Doberman Pinschers	Mrs. Barbara L. Burns*	Mr. Jay Richardson

Open classes divided: Black; Any other allowed color

Dogue de Bordeaux	Mr. Ken J. Murray	Mr. Jay Richardson
German Pinschers	Mr. Ken J. Murray	Mr. Jay Richardson
Giant Schnauzers	Mr. Ken J. Murray	Mr. Jay Richardson
Great Danes	Mr. Ken J. Murray	Mr. Jay Richardson

Open classes divided: Black; Blue; Brindle; Fawn; Harlequin; Mantle; Merle

Great Pyrenees	Mr. Ken J. Murray	Mr. Jay Richardson
Greater Swiss Mountain Dogs	Mr. Ken J. Murray	Mr. Jay Richardson
Komondorok	Mr. Ken J. Murray	Mr. Jay Richardson
Kuvaszok	Mr. Ken J. Murray	Mr. Jay Richardson
Leonbergers	Mrs. Barbara L. Burns*	Mr. Jay Richardson
Mastiffs	Mr. Ken J. Murray	Mr. Jay Richardson
Neapolitan Mastiffs	Mrs. Barbara L. Burns*	Mr. Jay Richardson
Newfoundlands	Mr. Ken J. Murray	Mr. Jay Richardson
Portuguese Water Dogs	Mr. Ken J. Murray	Mr. Jay Richardson
Rottweilers	Mr. Ken J. Murray	Mr. Jay Richardson
St. Bernards	Mr. Ken J. Murray	Mr. Jay Richardson

Open classes divided: Longhaired; Shorthaired

Samoyeds	Mr. Ken J. Murray	Mr. Jay Richardson
Siberian Huskies	Mr. Ken J. Murray	Mr. Jay Richardson
Standard Schnauzers	Mr. Ken J. Murray	Mr. Jay Richardson
Tibetan Mastiffs	Mr. Ken J. Murray	Mr. Jay Richardson

TERRIER BREEDS SATURDAY SUNDAY

Airedale Terriers	Mrs. Paula Hartinger	Mr. Roger R. Hartinger
American Hairless Terrier	Mrs. Paula Hartinger	Mr. Jay Richardson
American Staffordshire Terriers	Mrs. Paula Hartinger	Mr. Roger R. Hartinger
Australian Terriers	Mrs. Barbara L. Burns*	Mr. Roger R. Hartinger
Bedlington Terriers	Mrs. Paula Hartinger	Mr. Roger R. Hartinger
Border Terriers	Mrs. Paula Hartinger	Mr. Jay Richardson
Bull Terriers (Colored)	Mrs. Paula Hartinger	Mr. Roger R. Hartinger
Bull Terriers (White)	Mrs. Paula Hartinger	Mr. Roger R. Hartinger
Cairn Terriers	Mrs. Paula Hartinger	Mr. Roger R. Hartinger
Cesky Terrier	Mrs. Paula Hartinger	Mr. Roger R. Hartinger
Dandie Dinmont Terriers	Mrs. Paula Hartinger	Mr. Roger R. Hartinger
Fox Terriers (Smooth)	Mrs. Paula Hartinger	Mr. Roger R. Hartinger

10 Stone City Kennel Club, Saturday, October 5, 2019 & Sunday, October 6, 2019

Fox Terriers (Wire)	Mrs. Paula Hartinger	Mr. Roger R. Hartinger
Glen of Imaal Terriers	Mrs. Paula Hartinger	Mr. Roger R. Hartinger
Irish Terriers	Mrs. Paula Hartinger	Mr. Roger R. Hartinger
Kerry Blue Terriers	Mrs. Paula Hartinger	Mr. Roger R. Hartinger
Lakeland Terriers	Mrs. Paula Hartinger	Mr. Roger R. Hartinger
Manchester Terriers (Standard)	Mrs. Paula Hartinger	Mr. Roger R. Hartinger
Miniature Bull Terriers	Mrs. Paula Hartinger	Mr. Roger R. Hartinger
Miniature Schnauzers	Mrs. Paula Hartinger	Mr. Roger R. Hartinger
Norfolk Terriers	Mrs. Paula Hartinger	Mr. Roger R. Hartinger
Norwich Terriers	Mrs. Paula Hartinger	Mr. Roger R. Hartinger
Parson Russell Terriers	Mrs. Paula Hartinger	Mr. Roger R. Hartinger
Rat Terriers	Mrs. Barbara L. Burns	Mr. Roger R. Hartinger
Russell Terriers	Mrs. Paula Hartinger	Mr. Roger R. Hartinger
Scottish Terriers	Mrs. Paula Hartinger	Mr. Roger R. Hartinger
Sealyham Terriers	Mrs. Paula Hartinger	Mr. Roger R. Hartinger
Skye Terriers	Mrs. Barbara L. Burns	Mr. Roger R. Hartinger
Soft Coated Wheaten Terriers	Mrs. Paula Hartinger	Mr. Jay Richardson
Staffordshire Bull Terriers	Mrs. Paula Hartinger	Mr. Roger R. Hartinger
Welsh Terriers	Mrs. Paula Hartinger	Mr. Roger R. Hartinger
West Highland White Terriers	Mrs. Paula Hartinger	Mr. Roger R. Hartinger

TOY BREEDS SATURDAY SUNDAY

Affenpinschers	Mr. Roger R. Hartinger	Mrs. Paula Hartinger
Brussels Griffons	Mr. Roger R. Hartinger	Mrs. Judy English Murray
Cavalier King Charles Spaniels	Mr. Roger R. Hartinger	Mrs. Paula Hartinger
Chihuahua (Long Coat)	Mrs. Carol Steiner*	Mrs. Paula Hartinger
Chihuahua (Smooth Coat)	Mrs. Carol Steiner*	Mrs. Paula Hartinger
Chinese Crested	Mr. Roger R. Hartinger	Mrs. Paula Hartinger
English Toy Spaniels (Blenheim & Prince Charles)	Mr. Roger R. Hartinger	Mrs. Paula Hartinger
English Toy Spaniels (King Charles & Ruby)	Mr. Roger R. Hartinger	Mrs. Paula Hartinger

Havanese	Mr. Roger R. Hartinger	Mrs. Paula Hartinger
Italian Greyhounds	Mr. Roger R. Hartinger	Mrs. Paula Hartinger
Japanese Chin	Mr. Roger R. Hartinger	Mrs. Judy English Murray
Maltese	Mr. Roger R. Hartinger	Mrs. Paula Hartinger
Manchester Terriers (Toy)	Mr. Roger R. Hartinger	Mrs. Paula Hartinger
Miniature Pinschers	Mr. Roger R. Hartinger	Mrs. Paula Hartinger
Papillons	Mr. Roger R. Hartinger	Mrs. Judy English Murray
Pekingese	Mr. Roger R. Hartinger	Mrs. Paula Hartinger

Open classes divided: Under 8 lbs if 12 mos old or older 8 lbs & over & under 8 lbs if less than 12 mos old.

Pomeranians	Mr. Roger R. Hartinger	Mrs. Judy English Murray
Poodles (Toy)	NOT OFFERED	Mrs. Judy English Murray
Pugs	Mr. Roger R. Hartinger	Mrs. Judy English Murray
Shih Tzu	Mr. Roger R. Hartinger	Mrs. Paula Hartinger
Silky Terriers	Mr. Roger R. Hartinger	Mrs. Paula Hartinger
Toy Fox Terriers	Mr. Roger R. Hartinger	Mrs. Paula Hartinger
Yorkshire Terriers	Mr. Roger R. Hartinger	Mrs. Paula Hartinger

NON-SPORTING BREEDS SATURDAY SUNDAY

American Eskimo Dogs	Mrs. Paula Hartinger	Mrs. Judy English Murray
Bichons Frises	Mrs. Paula Hartinger	Mrs. Judy English Murray
Boston Terriers	Mrs. Paula Hartinger	Mrs. Judy English Murray
Open classes divided: Under 15 lbs; 15 lbs & under 20 lbs; 20 lbs & not to exceed 25 lbs.		
Bulldogs	Mrs. Paula Hartinger	Mrs. Judy English Murray
Chinese Shar-Pei	Mrs. Paula Hartinger	Mrs. Judy English Murray
Chow Chows	Mrs. Paula Hartinger	Mrs. Judy English Murray

Open classes divided: Black; Red; Any other color

Coton de Tulear	Mrs. Paula Hartinger	Mrs. Judy English Murray
Dalmatians	Mrs. Paula Hartinger	Mr. Jay Richardson
Finnish Spitz	Mrs. Paula Hartinger	Mrs. Judy English Murray
French Bulldogs	Mrs. Paula Hartinger	Mrs. Judy English Murray
Keeshonden	NOT OFFERED	NOT OFFERED

Lhasa Apsos	Mrs. Paula Hartinger	Mrs. Judy English Murray
Lowchen	Mrs. Paula Hartinger	Mrs. Judy English Murray
Norwegian Lundehund	Mrs. Paula Hartinger	Mrs. Judy English Murray
Poodles (Miniature)	NOT OFFERED	Mrs. Judy English Murray
Poodles (Standard)	NOT OFFERED	Mrs. Judy English Murray
Schipperkes	Mrs. Paula Hartinger	Mrs. Judy English Murray
Shiba Inu	Mrs. Paula Hartinger	Mrs. Judy English Murray
Tibetan Spaniels	Mrs. Paula Hartinger	Mrs. Judy English Murray
Tibetan Terriers	Mrs. Paula Hartinger	Mrs. Judy English Murray
Xoloitzcuintli	Mrs. Paula Hartinger	Mrs. Judy English Murray

Open classes divided: Toy, Miniature & Standard

HERDING BREEDS SATURDAY SUNDAY

Australian Cattle Dogs	Mr. Roger R. Hartinger	Mrs. Paula Hartinger
Australian Shepherds	Mr. Roger R. Hartinger	Mrs. Paula Hartinger
Open classes divided: Black; Blue Merle; Red; Red Merle		
Bearded Collies	Mrs. Carol Steiner*	Mrs. Paula Hartinger
Beaucerons	Mr. Roger R. Hartinger	Mrs. Paula Hartinger
Belgian Malinois	Mr. Roger R. Hartinger	Mrs. Paula Hartinger
Belgian Sheepdogs	Mr. Roger R. Hartinger	Mrs. Paula Hartinger
Belgian Tervuren	Mr. Roger R. Hartinger	Mrs. Paula Hartinger
Bergamasco Sheepdogs	Mr. Roger R. Hartinger	Mrs. Paula Hartinger
Berger Picards	Mr. Roger R. Hartinger	Mrs. Paula Hartinger
Border Collies	Mr. Roger R. Hartinger	Mrs. Paula Hartinger
Bouvier des Flandres	Mr. Roger R. Hartinger	Mrs. Paula Hartinger
Briards	Mr. Roger R. Hartinger	Mrs. Paula Hartinger
Canaan Dogs	Mr. Roger R. Hartinger	Mrs. Paula Hartinger
Cardigan Welsh Corgis	Mr. Roger R. Hartinger	Mrs. Paula Hartinger
Collies (Rough)	Mrs. Carol Steiner	Mrs. Paula Hartinger
Open classes divided: Blue Merle; Sable & White; Tri Color; White		
Collies (Smooth)	Mrs. Carol Steiner	Mrs. Paula Hartinger
Entlebucher Mountain Dogs	Mr. Roger R. Hartinger	Mrs. Paula Hartinger
Finnish Lapphunds	Mr. Roger R. Hartinger	Mrs. Paula Hartinger
German Shepherd Dogs	Mr. Roger R. Hartinger	Mrs. Paula Hartinger
Icelandic Sheepdogs	Mr. Roger R. Hartinger	Mrs. Paula Hartinger
Miniature American Shepherds	Mr. Roger R. Hartinger	Mrs. Paula Hartinger
Norwegian Buhunds	Mr. Roger R. Hartinger	Mrs. Paula Hartinger
Old English Sheepdogs	Mr. Roger R. Hartinger	Mrs. Paula Hartinger
Pembroke Welsh Corgis	Mr. Roger R. Hartinger	Mrs. Paula Hartinger
Polish Lowland Sheepdogs	Mr. Roger R. Hartinger	Mrs. Paula Hartinger
Pulik	Mr. Roger R. Hartinger	Mrs. Paula Hartinger
Pumik	Mr. Roger R. Hartinger	Mrs. Paula Hartinger
Pyrenean Shepherd	Mr. Roger R. Hartinger	Mrs. Paula Hartinger
Shetland Sheepdogs	Mrs. Carol Steiner	Mrs. Paula Hartinger
Open classes divided: Sable & White; Any other allowed color.		
Spanish Water Dogs	Mr. Roger R. Hartinger	Mrs. Paula Hartinger
Swedish Vallhunds	Mr. Roger R. Hartinger	Mrs. Paula Hartinger

MISCELLANEOUS BREEDS SATURDAY SUNDAY

Puppy Class, Bred-by-Exhibitor Class & Open Class will be offered in each breed, divided by sex. Dogs entered in Miscellaneous Classes are not eligible for points toward AKC Championship & are not eligible to compete in Variety Groups.

Barbets, Belgian Laekenois, Biewer Terriers, Bracco Italianos, Dogo Argentinos, Dutch Shepherds, Lancashire Heelers, Mudi, Norrbottenspets, Peruvian Inca Orchids, Portuguese Podengos, Russian Toys & Teddy Roosevelt Terriers.

Mr. Roger R. Hartinger Mrs. Paula Hartinger

JUNIOR SHOWMANSHIP SATURDAY SUNDAY

Novice Junior, Novice Intermediate, Novice Senior, Open Junior, Open Intermediate, Open Senior & Master Classes

Mr. Ken J. Murray Mr. Jay Richardson

**SATURDAY, OCTOBER 5, 2019
BEST IN SHOW, RESERVE BEST IN SHOW
AND VARIETY GROUP PRIZES**

BEST IN SHOW
\$100.00 CASH
and **RED, WHITE & BLUE ROSETTE**
offered by Stone City Kennel Club
RESERVE BEST IN SHOW
\$50.00 CASH

and **YELLOW & WHITE ROSETTE**
offered by Stone City Kennel Club
VARIETY GROUP PRIZES
FIRST IN EACH VARIETY GROUP
\$25.00 CASH

offered by Stone City Kennel Club, unless otherwise specified
TOY GROUP-offered by Kellog Toy Group Award.
*Rosettes are offered for First through Fourth Place
in each Variety Group by Stone City Kennel Club*

ALL TROPHIES MUST BE CLAIMED DAY OF SHOW -NONE WILL BE MAILED-

**SATURDAY, OCTOBER 5, 2019 BREED PRIZES
SPORTING BREEDS
SETTERS (IRISH)**

The Western Irish Setter Club, Inc., will support the entry of their Breed at this Show. The following prizes are offered through the generosity of the members and friends of the Western Irish Setter Club. Irish Setter designs made by Jan Ziech.

BEST OF BREED-Blanket.
BEST OF OPPOSITE SEX TO BEST OF BREED-Blanket.
WINNERS DOG-Blanket.
WINNERS BITCH-Blanket.
FIRST IN EACH REGULAR CLASS-Metal Spray Bottle.

**SATURDAY, OCTOBER 5, 2019
JUNIOR SHOWMANSHIP COMPETITION PRIZES**

The following Prizes are offered by Stone City Kennel Club, unless otherwise specified.

BEST JUNIOR HANDLER-3-streamer Rosette.
BEST JUNIOR HANDLER-8" x 10" Full Color Photograph offered by Robert Skibinski.
RESERVE BEST JUNIOR HANDLER-2-streamer Rosette.

SUNDAY, OCTOBER 6, 2019
BEST IN SHOW, RESERVE BEST IN SHOW
AND VARIETY GROUP PRIZES

BEST IN SHOW

\$100.00 CASH

and **RED, WHITE & BLUE ROSETTE**

offered by Stone City Kennel Club

RESERVE BEST IN SHOW

\$50.00 CASH

and **YELLOW & WHITE ROSETTE**

offered by Stone City Kennel Club

VARIETY GROUP PRIZES

FIRST IN EACH VARIETY GROUP

\$25.00 CASH

offered by Stone City Kennel Club, unless otherwise specified

TOY GROUP-offered by Kellogg Toy Group Award.

Rosettes are offered for First through Fourth Place

in each Variety Group by Stone City Kennel Club

ALL TROPHIES MUST BE CLAIMED DAY OF SHOW -NONE WILL BE MAILED-

SUNDAY, OCTOBER 6, 2019 BREED PRIZES
SPORTING BREEDS
SETTERS (IRISH)

The Western Irish Setter Club, Inc., will support the entry of their Breed at this Show. The following prizes are offered through the generosity of the members and friends of the Western Irish Setter Club. Irish Setter designs made by Jan Ziech.

BEST OF BREED-Stainless-Steel Water Bottle.

BEST OF OPPOSITE SEX TO BEST OF BREED-Stainless-Steel Water Bottle.

WINNERS DOG-Stainless-Steel Water Bottle.

WINNERS BITCH-Stainless-Steel Water Bottle.

FIRST IN EACH REGULAR CLASS-Treat Jar.

SUNDAY, OCTOBER 6, 2019
JUNIOR SHOWMANSHIP COMPETITION PRIZES

The following Prizes are offered by Stone City Kennel Club, unless otherwise specified.

BEST JUNIOR HANDLER-3-streamer Rosette.

BEST JUNIOR HANDLER-8" x 10" Full Color Photograph offered by Robert Skibinski.

RESERVE BEST JUNIOR HANDLER-2-streamer Rosette.

NOTICE TO EXHIBITORS

IF, BECAUSE OF RIOTS, CIVIL DISTURBANCES, OR OTHER ACTS BEYOND THE CONTROL OF THE MANAGEMENT IT IS IMPOSSIBLE TO OPEN OR TO COMPLETE THIS SHOW, NO REFUND OF ENTRY FEE WILL BE MADE. THE WELL BEING OF THE DOGS, EXHIBITORS AND SPECTATORS IS OF PARAMOUNT IMPORTANCE, AND IN THE EVENT IT IS NECESSARY TO CANCEL OR STOP THE EVENT BEFORE COMPLETION, NO REFUND OF ENTRY FEE WILL BE MADE. ENTRY FEES shall not be refunded in the event that a dog is absent, disqualified, excused by Veterinarian or Judge or barred from competition by action of Show Committee. We will make every effort to find duplicate entries, but if entry is processed, NO REFUND SHALL BE MADE.

ENTRY FORM changes, additions, corrections and cancellations **MUST** be received in writing or by telegram prior to the closing of entries, and **MUST INCLUDE AKC NUMBER AND BREED OF DOG.** Those received by telephone are **NOT** acceptable. **SUBSTITUTIONS REQUIRE A NEW COMPLETED ENTRY FORM.**

CANCELLATIONS MUST BE LEGIBLE AND MUST INCLUDE AKC NUMBER OR NO REFUND WILL BE ISSUED!! A \$2.00 ADMINISTRATIVE/PROCESSING FEE PER ENTRY WILL BE DEDUCTED.

NOTE: TO FIND OUT ABOUT ANY AKC EVENT CANCELLATIONS CALL THE AKC EVENT CANCELLATION HOTLINE (877) 252-3229.

NO ENTRY shall be made and no entry shall be accepted which specifies any condition as to its acceptance.

NO ENTRY will be accepted in the office of Roy Jones Dog Shows, Inc./SLEEPER, SUPT. IF IT IS RECEIVED AFTER 12:00 NOON ON THE PUBLISHED DAY OF CLOSING. ANY ENTRY RECEIVED AFTER 12:00 NOON ON THE PUBLISHED DAY OF CLOSING WILL BE RETURNED.

DUE TO THE LARGE VOLUME OF ENTRIES COMING IN AT THE LAST MINUTE, ANY ENTRY MISSING CRUCIAL INFORMATION OR ANY FAX ENTRY MISSING AUTHORIZATION FOR US TO USE YOUR CREDIT CARD FOR ENTRY FEES AND FAX FEES, MAY NOT BE CONTACTED AND WILL NOT BE PROCESSED.

ENTRIES WILL BE ACKNOWLEDGED AFTER ENTRIES CLOSE with Ident. Card and Judging Program. Should such acknowledgment not be received by the exhibitor within a reasonable time, please notify Roy Jones Dog Shows at 260-925-0525. The person accompanying the dog must show identification before the dog will be received.

ONE CHECK IS SUFFICIENT for all entries enclosed. ALL CHECKS must have Show(s) & Breed(s) entered written on the face. **EACH DOG MUST BE ENTERED ON A SEPARATE ENTRY FORM.**

PLEASE NOTE ALL CHANGES IN INFORMATION on the entry form, otherwise they will not be made.

ANY ENTRIES received with post-dated checks will be returned. **THIRD PARTY CHECKS WILL NOT BE ACCEPTED!**

STREET ADDRESS-FOR OVERNIGHT PRIVATE CARRIERS ONLY-1105 W. AUBURN DR., AUBURN, IN 46706. Roy Jones Dog Shows, Inc., Email Address: rjds@royjonesdogshows.com

FAX RULES: \$5.00 per entry (subject to change) is added for FAX entries. **Along with the front and the back of each entry form, we need a cover letter stating that you authorize Roy Jones Dog Shows, Inc. to use your Visa, MasterCard, Discover or American Express for the following entry fees and fax fees. Then you need to print the card number, expiration date, Cardholders name, address, daytime phone number. A written signature on the cover letter is required. This written authorization is required to process faxed entries. CARDHOLDERS WHOSE CHARGES ARE DECLINED BY THE BANK CARD AUTHORIZATION CENTER WILL NOT BE PROCESSED. CREDIT CARD RE-PROCESSING FEE IS \$10.00.** ALL entries, cancellations, etc., received by fax require show, breed, and AKC number. ALL transactions involving cancellations, class changes, or transfers will be charged a minimum of \$2.00 per entry. **FAX ENTRIES RECEIVED AFTER NOON ON DATE OF CLOSING/ILLEGIBLE ENTRIES WILL NOT BE PROCESSED, NOR WILL NOTIFICATION BE MADE. OUR FAX NUMBER IS 260-925-1146.**

THE OWNER OR HANDLER of each dog is solely responsible for having it ready at ringside when its class is to be judged. The Show-Giving Club and Superintendent/Event Secretary have no obligation or responsibility for providing service through a public address system, or stewards or runners for the purpose of locating dogs that are not brought into the ring when required.

ALL EXHIBITORS ARE RESPONSIBLE FOR CLEANING UP AFTER THEMSELVES AND THEIR DOGS!

THE SHOW-GIVING CLUB, the Show Superintendent/Event Secretary, their Agents, employees, etc., assume no responsibility for any loss, damage, or injury sustained by the exhibitors, handlers, or to any of their dogs or property, and further assume no responsibility for injury to children not under the control of their parents or guardians.

ANYONE SMOKING IN THE RINGS will be responsible for any damage done to matting due to extinguishing smoking materials on them!

ONLY DOGS THAT ARE AKC ELIGIBLE ARE ALLOWED ON THE SHOW GROUNDS.

ALL VIDEOTAPING, PHOTOGRAPHY OR ANY REPRODUCTION OF ANY MEANS during the Show requires Club permission.

PLEASE REMEMBER TO TURN OFF CELL PHONES AND/OR PAGERS BEFORE ENTERING RINGS.

RAMP BREEDS: Designated ramp breeds may be examined on the ground or on a ramp during breed judging according to the sole discretion of the judge & not the exhibitor. The entire entry in that breed is to be examined on the ground or on a ramp. **Approved ramp breeds: (WHERE APPLICABLE)**

Lagotti Romagnoli, American Water Spaniels, Boykin Spaniels, Clumber Spaniels, English Springer Spaniels, Field Spaniels, Sussex Spaniels*, Welsh Springer Spaniels, Basset Hounds*, Cirnechi dell'Etna, Grand Basset Griffon Vendeens, Whippets, Standard Schnauzers, American Staffordshire Terriers, Irish Terriers, Kerry Blue Terriers, Soft Coated Wheaten Terriers, Staffordshire Bull Terriers, Bulldogs*, Chinese Shar-Pei*, Chow Chows*, Finish Spitz, Keeshonden, Entlebucher Mountain Dogs, Finnish Lapphunds, Icelandic Sheepdogs, Norwegian Buhunds, Polish Lowland Sheepdogs, Spanish Water Dogs, Mudi (misc) & Norrbottenspets (misc).

*By Board approved policy Sussex Spaniels, Basset Hounds, Bulldogs, Chinese Shar-Pei & Chow Chows must be judged on the ramp in all conformation competition associated with AKC conformation dog shows or at which AKC conformation titles may be earned.

A judge requesting the use of a ramp must give reasonable notice to the Show Superintendent/Event Secretary prior to judging. AKC approval is not required. This policy extends to Junior Showmanship, the 4-6 Month Beginner Puppy Competition, the AKC National Owner Handled Series (NOHS), and all other special attractions that offer Group and BIS competitions. The list of Table and Ramp breeds can be found on the AKC Website under Conformation Judges - Announcements. Emergencies In emergency situations, with the approval of the Show Chair, breeds customarily examined on the ground may be examined on a ramp, not on a table. An emergency is defined as a temporary condition that arose immediately prior to or at a dog show. Convalescence from a medical procedure, illness and recuperation from injuries are examples of conditions that are not emergencies. The emergency use of a ramp may be allowed on a day and may be extended to include a cluster as well as judging either a group and/or Best In Show.

(In all but emergency situations, the exhibitor has no recourse. In an emergency situation, where use of a ramp is not indicated in the premium list, an exhibitor has the option of withdrawing their entry and receiving a refund.)

OFFICIAL AMERICAN KENNEL CLUB ENTRY FORM

STONE CITY KENNEL CLUB

- Dog Show & Junior Showmanship EVENT # 2019004925 - SATURDAY, OCTOBER 5, 2019
 Dog Show & Junior Showmanship EVENT # 2019004926 - SUNDAY, OCTOBER 6, 2019
WEITENDORF AGRICULTURAL EDUCATIONAL CENTER OF JOILET JUNIOR COLLEGE
17840 Laraway Road, JOLIET, IL 60433

CHECK THE BOX(ES) INDICATING WHICH DAY(S) YOU ARE ENTERING
ENTRY FORM MUST BE EXACTLY THE SAME FOR EACH DAY

ENTRY FEE is \$28.00 for the first entry of each dog for each event, except for Puppy Classes & Breed-by-Exhibitor which are \$24.00 for each event. Each Additional Entry of the same dog is \$10.00 for each event. JUNIOR SHOWMANSHIP is \$24.00 for each event if entered for 'Junior Showmanship Only' or if an Additional Entry; \$10.00 for each event. Fees include the 50¢ AKC Recording Fee and the \$3.00 AKC Event Service Fee on the first entry of a dog and a \$3.00 AKC Event Service Fee for each additional entry of the same dog in the regular and non-regular recordable single entry classes. (There is no recording fee or event service fee for junior showmanship, sweepstakes, futurities, brace/team, multi-dog classes, or special attractions.) ENTRIES CLOSE at Superintendent's Office, WEDNESDAY NOON (EDT), SEPTEMBER 18, 2019, after which time entries will not be accepted, cancelled, altered or substituted, except as provided for in Chapter 11, Section 6 of the Dog Show Rules.

When a dog is entered in more than one class, the highest priced class is considered the first entry. MAKE CHECKS and Money Orders payable to Roy Jones Dog Shows, Inc. (Returned Check Charge \$40.00). All Checks Must Have Show(s) & Breed(s) entered written on the face. THIRD PARTY CHECKS WILL NOT BE ACCEPTED!

ALL ENTRIES MUST BE SUBMITTED ON OFFICIAL AKC ENTRY FORMS, one dog per entry form. Photocopies of front & back will be accepted only if legible, and official AKC size.

MAIL ENTRIES with Fees to Superintendent, ROY JONES DOG SHOWS, INC., P.O. BOX 828, AUBURN, IN 46706.

ENTRIES WILL NOT BE ACCEPTED WITHOUT SIGNATURE, FEES AND BACK ON ENTRY FORM WITH AGREEMENT, NOR WILL CREDIT CARDS BE ACCEPTED FOR MAIL-IN ENTRIES.

ALL ENTRIES MUST BE SUBMITTED with checks drawn on U.S. Institutions or with International Money Orders in U.S. Funds.

ENCLOSE \$ _____ for entry fees

IMPORTANT-Read Carefully Instructions on Reverse Side Before Filling Out. Numbers in the boxes indicate sections of the instructions relevant to the information needed in that box (PLEASE PRINT)

BREED ⁵	VARIETY ¹	SEX
--------------------	----------------------	-----

DOG ^{2,3} SHOW CLASS	CLASS DIVISION ³ Weight, color, etc.
----------------------------------	--

ADDITIONAL CLASSES	OBEEDIENCE CLASS (Jump Height) NOT OFFERED	RALLY CLASS (Jump Height) NOT OFFERED	JR. SHOWMANSHIP CLASS
--------------------	--	---	-----------------------

NAME OF (See Back) JUNIOR HANDLER (if any)	JR. HANDLER NUMBER
---	--------------------

FULL NAME OF DOG

(Enter number here)	DATE OF BIRTH
<input type="checkbox"/> AKC® NO. <input type="checkbox"/> PAL/ILP NO. <input type="checkbox"/> FOREIGN REG. NO. & COUNTRY	PLACE OF BIRTH (list country) Do not print the above in catalog.

BREEDER _____

SIRE _____

DAM _____

ACTUAL OWNER(S)⁴ _____ (Please Print)

OWNER'S ADDRESS _____

CITY _____ STATE _____ ZIP _____

NAME OF OWNER'S AGENT (IF ANY) AT THE SHOW _____

I CERTIFY that I am the actual owner of the dog, or that I am the duly authorized agent of the actual owner whose name I have entered above. In consideration of the acceptance of this entry, I (we) agree to abide by the rules and regulations of the American Kennel Club in effect at the time of this event, and by any additional rules and regulations appearing in the premium list for this event, and further agree to be bound by the "Agreement" printed on the reverse side of this entry form. I (we) certify and represent that the dog entered is not a hazard to persons or other dogs. This entry is submitted for acceptance on the foregoing representation and Agreement. I (we) agree to conduct myself (ourselves) in accordance with all such Rules and Regulations (including all provisions applying to discipline) and to abide by any decisions made in accord with them.

SIGNATURE of owner or his/her agent

 duly authorized to make this entry _____

TELEPHONE # _____ Are you a new exhibitor? Yes No Owner/Handled Eligible? Yes No

E-MAIL Address (An acknowledgement or receipt of entry may be sent to this e-mail address): _____

Emergency contact: _____ Telephone _____

AKC Rules, Regulations, Policies and Guidelines are available on the American Kennel Club Web site www.akc.org

AGREEMENT

I (we) agree that the club holding this event has the right to refuse this entry for cause which the club shall deem sufficient. In consideration of the acceptance of this entry and of the holding of this event and of the opportunity to have the dog judged and to win prizes, ribbons, or trophies, I (we) agree to hold the AKC, the event-giving club, their members, directors, governors, officers, agents, superintendents or event secretary and the owner and/or lessor of the premises and any provider of services that are necessary to hold this event and any employees or volunteers of the aforementioned parties, and any AKC approved judge, judging at this event, harmless from any claim for loss or injury which may be alleged to have been caused directly or indirectly to any person or thing by the act of this dog while in or about the event premises or grounds or near any entrance thereto, and I (we) personally assume all responsibility and liability for any such claim; and I (we) further agree to hold the aforementioned parties harmless from any claim for loss, injury or damage to this dog.

Additionally, I (we) hereby assume the sole responsibility for and agree to indemnify, defend and save the aforementioned parties harmless from any and all loss and expense (including legal fees) by reason of the liability imposed by law upon any of the aforementioned parties for damage because of bodily injuries, including death at any time resulting therefrom, sustained by any person or persons, including myself (ourselves), or on account of damage to property, arising out of or in consequence of my (our) participation in this event, however such, injuries, death or property damage may be caused, and whether or not the same may have been caused or may be alleged to have been caused by the negligence of the aforementioned parties or any of their employees, agents, or any other persons. I (WE) AGREE THAT ANY CAUSE OF ACTION, CONTROVERSY OR CLAIM ARISING OUT OF OR RELATED TO THE ENTRY, EXHIBITION OR ATTENDANCE AT THE EVENT BETWEEN THE AKC AND THE EVENT-GIVING CLUB (UNLESS OTHERWISE STATED IN ITS PREMIUM LIST) AND MYSELF (OURSELVES) OR AS TO THE CONSTRUCTION, INTERPRETATION AND EFFECT OF THIS AGREEMENT SHALL BE SETTLED BY ARBITRATION PURSUANT TO THE APPLICABLE RULES OF THE AMERICAN ARBITRATION ASSOCIATION. HOWEVER, PRIOR TO ARBITRATION ALL APPLICABLE AKC BYLAWS, RULES, REGULATIONS AND PROCEDURES MUST FIRST BE FOLLOWED AS SET FORTH IN THE AKC CHARTER AND BYLAWS, RULES, REGULATIONS, PUBLISHED POLICIES AND GUIDELINES.

INSTRUCTIONS

1. (Variety) if you are entering a dog of breed in which there are varieties for show purposes, please designate the particular variety you are entering, i.e., Cocker Spaniel (solid color black, ASCOB, parti-color), Beagles (not exceeding 13 in., over 13 in. but not exceeding 15 in.), Dachshunds (longhaired, smooth, wirehaired), Collies (rough, smooth), Bull Terriers (colored, white), Manchester Terriers (standard, toy), Chihuahuas (smooth coat, long coat), English Toy Spaniels (King Charles and Ruby, Blenheim and Prince Charles), Poodles (toy, miniature, standard).

2. The following categories of dogs may be entered and shown in Best of Breed competition: Dogs that are Champions of Record and dogs which, according to their owners' records, have completed the requirements for a championship, but whose championships are unconfirmed. The showing of unconfirmed Champions in Best of Breed competition is limited to a period of 90 days from the date of the show where the dog completed the requirements for a championship.

3. (Event Class) Consult the classification in this premium list. If the event class in which you are entering your dog is divided, then, in addition to designating the class, specify the particular division of the class in which you are entering your dog, i.e. age division, color division, weight division.

4. A dog must be entered in the name of the person who actually owned it at the time entries for an event closed. If a registered dog has been acquired by a new owner it must be entered in the name of its new owner in any event for which entries closed after the date of acquisition, regardless of whether the new owner has received the registration certificate indicating that the dog is recorded in his/her name. State on entry form whether transfer application has been mailed to the AKC. (For complete rules, refer to Chapter 11, Section 3.)

5. Mixed Breed dogs entering classes for Agility, Obedience, and Rally trials should mark Breed as "All-American Dog/Mixed Breed." Sire and Dam information shall remain blank for mixed breed entrants.

_____ If this entry is for Junior Showmanship, please give the following information:

JUNIOR SHOWMANSHIP _____ JR.'S DATE OF BIRTH _____

AKC JUNIOR HANDLER NUMBER _____

The above number MUST be included. Should you not have your Junior Handler number, this may be obtained from the American Kennel Club. Phone: (919) 233-9767.

By signing the entry form I (we) certify that the Junior Showman does not now, and will not at any time, act as an agent/handler for pay while continuing to compete in Junior Showmanship.

ADDRESS _____

CITY _____ STATE _____ ZIP _____

If Junior Handler is not the owner of the dog identified on the face of this form, what is the relationship of the Junior Handler to the Owner? _____

AEN999 (01/19) v1.0P Hybr_CF

CHECK HERE IF THIS IS NEW OWNER(S) CHECK HERE IF THIS IS NEW ADDRESS