

# COMBINED JUDGING PROGRAM

(UNBENCHED/INDOORS)

## 3 ALL-BREED DOG SHOWS

w/3 JUNIOR SHOWMANSHIP COMPETITIONS,  
1 OBEDIENCE TRIAL & 1 RALLY TRIAL  
ON FRIDAY & SATURDAY ONLY



EVENT #s 2019082605, 2019082611 & 2019082606

## BADGER KENNEL CLUB

(Member of the American Kennel Club)

FRIDAY, MAY 3, 2019 & SUNDAY, MAY 5, 2019

And EVENT #s 2019006806 & 2019006807

## JANESVILLE-BELOIT KENNEL CLUB

(Licensed by the American Kennel Club)

SATURDAY, MAY 4, 2019

Being held at **JEFFERSON COUNTY FAIR PARK** (Smoke Free Facility)

503 N Jackson Avenue, **JEFFERSON, WI 53549**

**THESE SHOWS WILL BE HELD INDOORS**

**ATTENDANCE FREE / PARKING - \$5.00 per day/ car or van**

**SHOW HOURS EACH DAY 6:00 A.M. to 6:00 P.M. - CDT**

Dogs are not required to be at the show until scheduled time of judging. All dogs not needed for further judging will be excused.

**SHOW LOCATION IS AVAILABLE TO EXHIBITORS AFTER 2:00 P.M.**

**THURSDAY, MAY 2, 2019. (See ATTENTION EXHIBITORS SEGMENT).**

**\*\*BUILDING IS FULLY HANDICAPPED ACCESSIBLE\*\***

**AUTOMATED DEFIBRILLATOR (AED) IS LOCATED  
INSIDE FRONT DOOR OF ACTIVITY CENTER**

**NEW EXHIBITOR - BRIEFING • NEW EXHIBITOR, ANY EXHIBITOR  
Please come to Superintendent's Table between 8:30 - 10:30 AM each day.**

American Kennel Club Annually Licensed Superintendents

**VIRGINIA W. SLEEPER DALE D. NEUKOM, JR.**

**JEFFERY W. INMAN**

**EVAN C. BRUDI CYNTHIA J. POOLE**

One or more of the above superintendents will superintend this show.

**SERVICES AND EQUIPMENT FURNISHED BY**

Post Office Box 828, Auburn, IN 46706

Phone (260) 925-0525 • Fax (260) 925-1146

[www.royjonesdogshows.com](http://www.royjonesdogshows.com)

**\* ATTENTION \* Online entries through our website!!!**



## OFFICIAL NOTICE \* ADDITIONAL JUDGES

CHAPTER 7, SECTION 13-ALL CANCELLATIONS MUST BE RECEIVED IN WRITING.

**FRIDAY, MAY 3, 2019**

Mrs. Sulie Greendale-Paveza will judge Poodles (Toy), Bulldogs, Dalmatians, Keeshonden, Poodles (Minature) & Schipperkes in place of Mr. Robert J. Shreve.

**SATURDAY, MAY 4, 2019**

Ms. Linda Robey will judge Rottweilers in place of Mrs. Sulie Greendale-Paveza.  
Mrs. Janie M. Bousek will judge Chinese Cresteds, Havanese, English Toy Spaniels (Blenheim & Prince Charles), Poodles (Toy) & Shih Tzu in place of Mr. Jason Hoke.

**SUNDAY, MAY 5, 2019**

Mr. Robert J. Shreve will judge Belgian Tervurens in place of Ms. Linda Robey.  
Mrs. Mareth K. Kipp will judge Labrador Retrievers in place of Ms. Linda Robey & Spaniels (Field) & Junior Showmanship in place of Mr. Jason Hoke.

**NO ENTRY CAN BE CHANGED EXCEPT AS PROVIDED FOR IN  
CHAPTER 11, SECTION 6 OF THE DOG SHOW RULES,  
CHAPTER 1, SECTION 16 OF THE OBEDIENCE REGULATIONS OR  
RALLY REGULATIONS CHAPTER 1, SECTION 13**

## JUDGES FOR ONE OR ALL THREE DAYS

Mrs. Janie M. Bousek, W6865 Windward Dr, Greenville, WI 54942-8690  
Mrs. Marcia Feld, 1054 Tamarack Ln, Libertyville, IL 60048-3617  
Ms. Karen Fitzpatrick, 4966W400N Road, Kankakee, IL 60901-7279  
Mrs. Sulie Greendale-Paveza, 56 Knoll Road, Hamden, CT 06518-1307  
Mr. Wayne F. Harmon, 425 Penn Ave S, Minneapolis, MN 55405-2061  
Mr. Jason Hoke, 314 S Midvale Blvd, Madison, WI 53705-5031  
Mr. Russell Hornfisher, 4603 Aggie Dr, Maryville, TN 37803-0671  
Mrs. Bonnie Hornfisher, 11645 Lehigh Ct, Plymouth, MI 48170-2800  
Mrs. Anne Katona, 2767 Sky Horse Trail, Reno, NV 89511-5373  
Mrs. Mareth K. Kipp, S54 W32292 County Road ZZ, North Prairie, WI 53153  
Mr. Richard Edwin Lake, 513 Leighs Bay Road Sault Saint Marie Ontario, Canada P6A 6K4  
Ms. Jennifer Landers, 3419 Fuller Dr, Midland, MI 48642-6676  
Dr. Edna K. Martin, 6020 W Egidi Ln, Libertyville, IL 60048-9430  
Mrs. Debbie L. Melgreen, 386 Knox Road 2300 E, Yates City, IL 61572-9328  
Ms. Susan Neidlinger, 308 Whipple St, Three Rivers, MI 49093  
Ms. Linda Robey, 4491 Green Valley Dr, High Ridge, MO 63049-2633  
Mr. Robert J. Shreve, 7979 W 28th St, Greeley, CO 80634-9647

## EMERGENCY CONTACT INFORMATION

**Friday & Sunday-608-577-1560**

**Saturday-608-756-0424**

NOTE: To find out about any AKC event cancellations call the AKC Event Cancellation Hotline (877) 252-3229.

## VETERINARIAN (Will be on Call)

Veterinary Emergency Services 2704 Royal Ave., Monona WI. 53716  
608-274-7772

**DIRECTIONS FROM the Show Grounds to Veterinary Emergency Services: 2704 Royal Ave, Madison WI 53716, 608-274-7772.** From fairgrounds entrance turn right, onto N. Jackson Ave. to stop sign. Turn right onto US-18W/W Racine Street. Take US 18W for 10.4 miles. Turn right onto US-12WUS-18W for 15 miles. Take exit 264 for South Towne Drive. Use left 2 lanes to turn left onto West Broadway. At traffic circle, take the first exit onto Industrial Drive. Turn right onto Mangrove Lane. Veterinary Clinic will be on your right.

## EMERGENCY VETERINARIAN

**DIRECTIONS FROM the Show Grounds to Veterinary Emergency Services - Janesville: 3710 E Racine St., Janesville, WI 53546 • 608-314-3510.** From Fairgrounds entrance, turn right, onto N. Jackson Ave. to stop sign. Turn right onto US-18W/W. Racine St. Turn left to merge onto WI-26S. Take WI-26S for 21 miles. Take exit 6 to N. Harmony Town Hall Rd. in Harmony. Continue on N. Harmony Town Hall Rd. for 6.9 miles. Turn left onto US-14E, 2.5 miles. Turn right onto US-14 Bus. W. Turn Left on S. Co Rd. JS Wright Rd. 3710 East Racine St. is on the left.

Judges are not required to wait for dogs. They will adhere as closely as possible to the judging schedule printed in this program. The owner or handler of each dog is solely responsible for having it ready at ringside when its class is to be judged. The show-giving Club and Superintendent have no obligation or responsibility for providing service through a public address system or stewards or runners for the purpose of calling or locating dogs that are not brought into the ring when required. Being an unbenched show, you need to be at show only in time for your judging and may leave any time after judging. Numbers before each Breed represent the number of dogs entered in (1) the regular dog classes; (2) regular bitch classes; (3) Specials Only, Best of Breed or Best of Variety Competition; and in (4) Non-Regular classes.

For your convenience, the following class divisions have been carefully tabulated; however, neither the Club nor the Superintendent assumes responsibility for absolute accuracy.

**AN ASTERISK IS USED TO DESIGNATE PROVISIONAL/PERMIT JUDGES**

## BADGER KENNEL CLUB/FRIDAY, MAY 3, 2019

There are 974 Dogs entered in this show with a total of 1003 entries and 131 different breeds.

There are 51 Dogs entered in Rally with a total of 60 entries and 28 different breeds.

### RING 1 HORSE BARN

**JUDGE: Mrs. Debbie L. Melgreen**  
**—160 ENTRIES**  
 8:00AM  
 3 RET-NSDT 1-0-1D,1B-0NR  
 3 SPINONE 0-1-2D,0B-0NR  
 2 PNTR-GW 0-1-0D,1B-0NR  
 6 WEIM 2-1-1D,2B-0NR  
 5 VIZS 1-1-1D,2B-0NR  
 6 PNTR-GS 0-2-2D,2B-0NR  
 9:00AM  
 2 SPAN-SUSSEX 0-1-0D,1B-0NR  
 1 POL LOW SHP 0-0-1D,0B-0NR  
 6 WIRE PTG GRIFN 1-1-2D,2B-0NR  
 2 COLLIE (SMOOTH) 2-0-0D,0B-0NR  
 15 RET-FLAT 5-3-5D,2B-0NR  
 10:00AM  
 35 RET-LAB 15-17-3D,0B-0NR  
 LUNCH 11:30AM  
 12:15PM  
 2 \*BELGIAN TERV 0-0-0D,2B-0NR  
 6 BOUVIER 0-3-1D,2B-0NR  
 17 COLLIE (ROUGH) 5-11-1D,0B-0NR  
 1:15PM  
 4 DACH (SMOOTH) 0-1-3D,0B-0NR  
 5 CARD WLSH CORGI 2-1-2D,0B-0NR  
 5 DACH (LONGHAIR) 0-3-2D,0B-0NR  
 16 SHETLAND SHEP 5-7-2D,2B-0NR  
 10 DACH (WIREHAIR) 1-3-5D,1B-0NR  
 2:45PM  
 9 JUNIOR SHOWMANSHIP ENTRIES  
 (3 NV JR, 1 NV INTR, 1 OP JR,  
 3 OP INTR, 1 OP SR)

### RING 2 HORSE BARN

**JUDGE: Mrs. Sulie Greendale-Paveza**  
**—146 DOGS**  
 8:00AM  
 2 GREYHND 0-0-0D,2B-0NR  
 1 REDBONE CHND 0-0-0D,1B-0NR  
 15 RHO RIDGE 6-4-4D,1B-0NR  
 8:45AM  
 2 IR WOLF 1-1-0D,0B-0NR  
 2 BORZ 0-0-1D,1B-0NR  
 1 AMER FOXHND 0-0-1D,0B-0NR  
 1 OTTERHND 0-0-0D,1B-0NR  
 4 SALUKI 0-2-1D,1B-0NR  
 5 BORDER COLLIES 0-3-1D,1B-0NR  
 10 GERM SHEP DOG 4-5-0D,1B-0NR  
 9:45AM  
 1 CANAAN DOGS 0-0-1D,0B-0NR  
 2 BERGER PICARD 0-1-1D,0B-0NR  
 2 BRIARD 0-1-0D,1B-0NR  
 20 AUST SHEPHERD 4-10-5D,1B-0NR

### RING 2 CON'T

10:45AM  
 1 GBGV 1-0-0D,0B-0NR  
 5 KEESHONDEN 0-2-2D,1B-0NR  
 7 BULLDOG 0-4-1D,2B-0NR  
 9 BASSET 3-1-3D,2B-0NR  
 6 WHIP 3-2-1D,0B-0NR  
 LUNCH 11:45AM  
 12:30PM  
 7 DALMATIAN 3-2-2D,0B-0NR  
 3 NOR ELK 1-1-1D,0B-0NR  
 7 OLD ENG SHEEPDG 2-1-1D,3B-0NR  
 4 AFGHAN 0-2-1D,1B-0NR  
 11 BEARDED COLLIE 4-6-1D,0B-0NR  
 1:45PM  
 2 POODLES (TOY) 0-2-0D,0B-0NR  
 1 BEAGLE-15 INCH 0-0-1D,0B-0NR  
 1 SWED VALLHUND 0-0-0D,1B-0NR  
 1 PULIK 0-0-1D,0B-0NR  
 2 BASENJIS 1-0-1D,0B-0NR  
 2 SCHIPPERKES 1-0-1D,0B-0NR  
 4 POODLE (MIN) 1-3-0D,0B-0NR  
 5 PEMB WLSH CORGI 0-2-3D,0B-0NR

### RING 3 HORSE BARN

**JUDGE: Ms. Linda Robey**  
**—154 DOGS (ALSO IN RING 7)**  
 8:00AM  
 8 SET-GORD 3-1-3D,1B-0NR  
 10 BRIT 1-4-5D,0B-0NR  
 8 SET-ENG 1-2-4D,1B-0NR  
 9:00AM  
 4 RET-CURL 0-3-1D,0B-0NR  
 9 SET-IRSH 2-4-2D,1B-0NR  
 2 SET-IRW 0-0-1D,1B-0NR  
 12 RET-CHESS 3-7-1D,1B-0NR  
 2 SPAN-AMW 0-1-1D,0B-0NR  
 7 SPAN-ENG CKR 2-3-2D,0B-0NR

### RING 4 HORSE BARN

**JUDGE: Mrs. Anne Katona**  
**—130 DOGS**  
 8:00AM  
 3 AIRDLE TERR 0-2-1D,0B-0NR  
 1 BULL(COLR) TERR 1-0-0D,0B-0NR  
 2 BULL(WHITE) TER 0-2-0D,0B-0NR  
 2 FOX TER(WIRE) 1-0-0D,0B-0NR  
 2 RAT TERR 2-0-0D,0B-0NR  
 3 BORDER TERR 0-1-1D,1B-0NR  
 5 FOX TER(SMOOTH) 4-1-0D,0B-0NR

## BADGER KENNEL CLUB/FRIDAY, MAY 3, 2019

### RING 4 CON'T

8:45AM  
 1 BRUSS GRIF 0-0-1D,0B-0NR  
 1 CHIHUA (LONG) 0-0-1D,0B-0NR  
 7 TOY FOX TER 2-2-2D,1B-0NR  
 6 AUSTR TERR 1-3-1D,1B-0NR  
 11 CHIN CREST 6-1-3D,1B-0NR  
 9:45AM  
 2 CHIHUA (SMOOTH) 0-1-1D,0B-0NR  
 1 AFFENPINSCHERS 0-1-0D,0B-0NR  
 2 BEDLGTN TERR 0-1-1D,0B-0NR  
 3 MIN SCHNAUZER 2-1-0D,0B-0NR  
 3 WEST HIGH WHT 2-0-1D,0B-0NR  
 5 PEKE 1-0-4D,0B-0NR  
 10 PAP 3-3-3D,1B-0NR  
 10:45PM  
 1 SILKY TERR 0-0-0D,1B-0NR  
 2 SHIH TZU 0-0-2D,0B-0NR  
 23 CAV KC SPAN 8-10-5D,0B-0NR  
 LUNCH 11:45AM  
 12:30PM  
 1 MALTESE 0-0-1D,0B-0NR  
 1 YORKSHIRE TERR 1-0-0D,0B-0NR  
 4 JAPANESE CHIN 1-2-1D,0B-0NR  
 10 POM 3-3-4D,0B-0NR  
 6 ENG TOY SP-BLEN 1-2-2D,1B-0NR  
 1 KERRY BLUE TERR 0-0-1D,0B-0NR  
 3 SOFT COAT WHTN 1-2-0D,0B-0NR  
 8 AM STAFF TERR 4-3-1D,0B-0NR

### RING 5 HORSE BARN

**JUDGE: Mr. Richard Edwin Lake**  
**—174 DOGS**  
 8:00AM  
 3 LEONBERGER 1-1-0D,1B-0NR  
 10 BOXER 3-4-2D,1B-0NR  
 8:30AM  
 1 STD SCHNAUZER 0-0-1D,0B-0NR  
 1 GTR SWISS MTN 0-0-1D,0B-0NR  
 6 ROTT 1-2-1D,2B-0NR  
 6 MASTIFF 2-2-2D,0B-0NR  
 11 BULLMASTIFF 2-3-5D,1B-0NR  
 9:30AM  
 25 GRT DANE 9-8-3D,5B-0NR  
 10:30AM  
 30 DOBE 9-15-3D,3B-0NR  
 LUNCH 11:45AM  
 12:30PM  
 9 ALAS MAL 0-3-3D,3B-0NR  
 18 PORT WATER DOG 6-5-4D,3B-0NR  
 1:30PM  
 11 SAMOYED 1-2-4D,4B-0NR  
 7 SIB HKY 3-1-2D,1B-0NR  
 9 BERNS MNT DOG 1-5-1D,2B-0NR  
 2:30PM  
 2 GIANT SCHN 0-2-0D,0B-0NR  
 2 NEWF 1-0-1D,0B-0NR  
 3 SCOTTI TERR 1-1-0D,1B-0NR  
 20 SPAN-ENG SPR 4-12-1D,3B-0NR

### RING 6 HORSE BARN

**JUDGE: Mr. Robert J. Shreve**  
**—175 DOGS**  
 8:00AM  
 1 TIBETAN SPAN 0-0-1D,0B-0NR  
 6 AM ESK DOG 1-0-2D,3B-0NR  
 8 SHIBA INU 1-5-2D,0B-0NR  
 5 LOWCHEN 2-2-1D,0B-0NR  
 6 \*PUGS 0-4-2D,0B-0NR  
 9:00AM  
 9 TIBETAN TERR 0-6-1D,2B-0NR  
 42 FRENCH BULLDOG 18-15-3D,6B-0NR  
 11:00AM  
 1 CHIN SHAR-PEI 0-0-1D,0B-0NR  
 12 SPAN-FLD 3-5-3D,1B-0NR  
 LUNCH 11:30AM  
 12:15PM  
 39 RET-GOLD 12-23-4D,0B-0NR  
 1:45PM  
 3 SPAN-CKR(BLACK) 0-0-1D,2B-0NR  
 2 SPAN-CKR(ASCOB) 1-1-0D,0B-0NR  
 3 BICHON 1-0-1D,1B-0NR  
 3 SPAN-CKR(PARTI) 2-0-0D,1B-0NR  
 3 COTON DE TULEAR 0-0-3D,0B-0NR  
 7 LHASA 2-4-1D,0B-0NR  
 12 BOSTON TERR 6-4-0D,2B-0NR  
 13 POODLE (STAND) 4-6-1D,2B-0NR

### RING 7 DRAFT HORSE BARN

**JUDGE: Ms. Linda Robey**  
**—154 DOGS (ALSO IN RING 3)**  
 10:45AM  
 92 SPAN-WEL SPR 22-35-16D,18B-0NR  
 LUNCH BREAK AT JUDGES DISCRETION

### RING 8 ACTIVITY CENTER

**JUDGE: Mrs. Bonnie Hornfisher**  
**—64 ENTRIES**  
 8:00AM  
 3 UTILITY A (43-45)  
 8:30AM  
 13 UTILITY B (46-58)  
 10:15AM  
 1 PRF UTLTY (73)  
 10:25AM  
 1 GRAD OPEN (74)  
 10:35AM  
 17 OPEN B (26-42)  
 LUNCH 12:45PM  
 1:30PM  
 3 OPEN A (23-25)  
**AFTER NOON**  
 2 PRFD OPEN (71-72)  
**NOVICE A WALK THRU**  
 4 NOV. A (11-14)  
 9 NOV. B (15-22)  
**PREFERRED NOVICE WALK THRU**  
 2 PRFD NOVICE (69-70)  
**BEGINNER NOVICE A & B WALK THRU**  
 3 BGNR NOVICE A (59-61)  
 7 BGNR NOVICE B (62-68)

# BADGER KENNEL CLUB/FRIDAY, MAY 3, 2019

## RING 9 ACTIVITY CENTER

JUDGE: Mr. Russell Hornfisher  
—60 ENTRIES

8:00AM  
Rally Master Set-up & Walk Thru  
6 RALLY MASTER (65-71)

8:30AM  
Rally Excellent A & B Set-up & Walk Thru  
2 RALLY EXCELLENT A (55-56)  
8 RALLY EXCELLENT B (57-64)

## RING 9 CON'T

9:15AM  
Rally Advanced B Set-up & Walk Thru  
8 RALLY ADVANCED B (47-54)

9:50AM  
Rally Intermediate Set-up & Walk Thru  
7 RALLY INTERMEDIATE (40-46)

10:20AM  
Rally Novice A & B Set-up & Walk Thru  
9 RALLY NOVICE A (11-19)  
20 RALLY NOVICE B (20-39)

## VARIETY GROUPS

3:45PM

ORDER OF GROUP JUDGING UNLESS OTHERWISE ANNOUNCED BY 2:30PM

## VARIETY GROUP JUDGES

WORKING GROUP ..... Mr. Robert J. Shreve  
HOUND GROUP ..... Mrs. Anne Katona  
SPORTING GROUP ..... Mrs. Debbie L. Melgreen  
HERDING GROUP ..... Mr. Robert J. Shreve  
TERRIER GROUP ..... Mrs. Anne Katona  
TOY GROUP ..... Mr. Richard Edwin Lake  
NON-SPORTING GROUP ..... Mr. Robert J. Shreve  
BEST IN SHOW ..... Ms. Linda Robey

## AKC NATIONAL OWNER-HANDLED GROUPS WILL START AT 3:00PM

WORKING ..... Mrs. Sulie Greendale-Paveza  
HOUND ..... Mrs. Debbie L. Melgreen  
SPORTING ..... Mrs. Anne Katona  
HERDING ..... Mr. Richard Edwin Lake  
TERRIER ..... Mr. Robert J. Shreve  
TOY ..... Mrs. Debbie L. Melgreen  
NON-SPORTING ..... Mrs. Sulie Greendale-Paveza  
BEST IN SHOW ..... Mr. Richard Edwin Lake

# JANESVILLE-BELOIT KENNEL CLUB

## SATURDAY, MAY 4, 2019

There are 1217 Dogs entered in this show with a total of 1314 entries and 143 different breeds.  
There are 52 Dogs entered in Rally with a total of 65 entries and 28 different breeds.

## RING 1 HORSE BARN

JUDGE: Mr. Robert J. Shreve  
—146 DOGS

8:00AM  
1 CANE CORSO 1-0-0D,0B-0NR  
14 ALAS MAL 3-5-3D,3B-0NR  
10 BERNIS MNT DOG 3-6-0D,1B-0NR  
9:00AM  
36 DOBE 12-16-4D,4B-0NR  
10:30AM  
18 BULLMASTIFF 4-7-5D,2B-0NR  
11:15AM  
3 GIANT SCHN 0-3-0D,0B-0NR  
2 AIRDLE TERR 0-1-1D,0B-0NR  
1 BULL(COLR) TERR 1-0-0D,0B-0NR  
3 BULL(WHITE) TERR 0-3-0D,0B-0NR  
2 KERRY BLUE TERR 0-0-2D,0B-0NR  
4 SOFT COAT WHTN 1-3-0D,0B-0NR  
1 IRISH TERR 0-0-1D,0B-0NR  
11 AM STAFF TERR 4-4-2D,1B-0NR  
LUNCH 12:15PM

## RING 1 CON'T

1:00PM  
2 FOX TER(WIRE) 1-0-0D,0B-0NR  
1 GLEN OF IMAAL 0-0-0D,1B-0NR  
1 RUSSEL TERR 0-1-0D,0B-0NR  
2 RAT TERR 2-0-0D,0B-0NR  
3 MIN SCHNAUZER 2-1-0D,0B-0NR  
4 BORDER TERR 0-1-2D,1B-0NR  
4 SCOTTI TERR 1-1-1D,1B-0NR  
3 WEST HIGH WHT 2-0-1D,0B-0NR  
5 FOX TER(SMOOTH) 4-1-0D,0B-0NR  
5 AUSTR TERR 1-3-1D,0B-0NR  
10 BEDLGTN TERR 4-5-1D,0B-0NR

# JANESVILLE-BELOIT KENNEL CLUB

## SATURDAY, MAY 4, 2019

## RING 2 HORSE BARN

JUDGE: Dr. Edna K. Martin  
—140 ENTRIES

8:00AM  
8 BASSET 4-1-2D,1B-0NR  
6 WHIP 2-2-1D,1B-0NR  
1 GBGV 1-0-0D,0B-0NR  
12 RHO RIDGE 5-4-2D,1B-0NR  
9:00AM  
1 AMER FOXHND 0-0-1D,0B-0NR  
1 REDBONE CHND 0-0-0D,1B-0NR  
3 GREYHND 0-1-0D,2B-0NR  
3 IBIZAN 2-1-0D,0B-0NR  
5 SALUKI 0-2-1D,2B-0NR  
6 SCOT DEER 4-1-1D,0B-0NR  
7 IR WOLF 3-4-0D,0B-0NR  
10:00AM  
1 OTTERHND 0-0-0D,1B-0NR  
3 NOR ELK 1-1-1D,0B-0NR  
6 AFGHAN 1-2-1D,2B-0NR  
12 BORZ 3-6-1D,2B-0NR  
12 DACH (LONGHAIR) 3-5-2D,2B-0NR  
LUNCH 11:30AM  
12:15PM  
11 DACH (SMOOTH) 1-7-3D,0B-0NR  
1 PORT PD PEQ 1-0-0D,0B-0NR  
2 BEAGLE-15 INCH 0-0-2D,0B-0NR  
3 BASENJIS 1-0-1D,1B-0NR  
14 DACH (WIREHAIR) 3-5-5D,1B-0NR  
1:30PM  
22 JUNIOR SHOWMANSHIP ENTRIES  
(3 NV JR, 3 NV INTR, 2 OP JR,  
8 OP INTR, 6 OP SR)

## RING 3 HORSE BARN

JUDGE: Mr. Jason Hoke  
—175 DOGS (ALSO IN RING 8)

8:00AM  
25 GRT DANE 9-8-4D,4B-0NR  
9:00AM  
1 SILKY TERR 0-0-0D,1B-0NR  
1 AFFENPINSCHERS 0-1-0D,0B-0NR  
1 BRUSS GRIF 0-0-1D,0B-0NR  
3 CHIHUA (SMOOTH) 0-2-1D,0B-0NR  
9 PUGS 1-6-2D,0B-0NR  
11 TOY FOX TER 4-3-2D,2B-0NR  
10:00AM  
3 CHIHUA (LONG) 0-1-2D,0B-0NR  
5 PEKE 1-0-4D,0B-0NR  
18 PAP 4-7-5D,2B-0NR  
11:00AM  
4 JAPANESE CHIN 1-2-1D,0B-0NR  
13 POM 5-3-5D,0B-0NR  
28 CAV KC SPAN 9-12-7D,0B-0NR  
LUNCH 12:45PM  
RING 3 HORSE BARN  
JUDGE: Mrs. Janie M. Bousek  
—22 DOGS  
12:45PM  
3 POODLES (TOY) 1-2-0D,0B-0NR  
2 HAVANESE 1-1-0D,0B-0NR  
2 SHIH TZU 1-0-1D,0B-0NR  
6 ENG TOY SP-BLEN 1-2-2D,1B-0NR  
9 CHIN CREST 5-1-2D,1B-0NR

## RING 4 HORSE BARN

JUDGE: Mr. Richard Edwin Lake  
—147 DOGS

8:00AM  
5 GERM SHEP DOG 2-2-0D,1B-0NR  
4 CANAAN DOGS 1-2-1D,0B-0NR  
9 COLLIE (SMOOTH) 4-3-1D,1B-0NR  
8:45AM  
2 AUST CATTLE DOG 2-0-0D,0B-0NR  
4 BERGER PICARD 0-2-1D,1B-0NR  
2 BRIARD 0-1-0D,1B-0NR  
6 BORDER COLLIES 0-4-1D,1B-0NR  
6 BELGIAN TERV 1-1-1D,3B-0NR  
6 BOUVIER 0-3-1D,2B-0NR  
9:45AM  
25 AUST SHEPHERD 6-13-5D,1B-0NR  
10:45AM  
31 COLLIE (ROUGH) 9-18-2D,2B-0NR  
LUNCH 12:00PM  
12:45PM  
1 POL LOW SHP 0-0-1D,0B-0NR  
8 OLD ENG SHEEPDG 2-2-1D,3B-0NR  
12 BEARDED COLLIE 4-6-2D,0B-0NR  
1 PULIK 0-0-1D,0B-0NR  
3 SWED VALLHUND 0-2-0D,1B-0NR  
2 CARD WLSH CORGI 1-0-1D,0B-0NR  
5 PEMB WLSH CORGI 0-2-3D,0B-0NR  
15 SHETLAND SHEP 5-7-2D,1B-0NR

## RING 5 HORSE BARN

JUDGE: Mrs. Sulie Greendale-Paveza  
—171 DOGS

8:00AM  
33 RET-LAB 14-16-3D,0B-0NR  
9:30AM  
4 RET-CURL 0-3-1D,0B-0NR  
10 SET-GORD 2-4-3D,1B-0NR  
12 BRIT 1-6-5D,0B-0NR  
10:30AM  
2 SET-IRW 0-0-1D,1B-0NR  
12 RET-CHES 3-7-1D,1B-0NR  
12 SET-ENG 1-4-5D,1B-0NR  
LUNCH 11:30AM  
12:15PM  
1 STD SCHNAUZER 0-0-1D,0B-0NR  
1 SPAN-CLUM 1-0-0D,0B-0NR  
2 SPAN-AMW 0-1-1D,0B-0NR  
24 SPAN-ENG SPR 5-14-2D,3B-0NR  
1:15PM  
7 SET-IRSH 1-3-2D,1B-0NR  
13 SPAN-ENG CKR 4-5-3D,1B-0NR  
7 MASTIFF 2-2-2D,1B-0NR  
2:15PM  
1 GTR SWISS MTN 0-0-1D,0B-0NR  
2 NEWF 1-0-1D,0B-0NR  
3 LEONBERGER 1-1-0D,1B-0NR  
3 ST BERN 1-2-0D,0B-0NR  
8 SIB HKY 3-3-1D,1B-0NR  
14 SAMOYED 2-2-4D,6B-0NR

# JANESVILLE-BELOIT KENNEL CLUB

## SATURDAY, MAY 4, 2019

### RING 6 HORSE BARN

**JUDGE: Mrs. Anne Katona**  
**—131 DOGS**  
8:00AM  
13 DALMATIAN 6-5-2D,0B-0NR  
4 CHIN SHAR-PEI 1-2-1D,0B-0NR  
7 BULLDOG 0-4-1D,2B-0NR

9:00AM  
2 TIBETAN SPAN 0-0-2D,0B-0NR  
5 LOWCHEN 2-2-1D,0B-0NR  
2 SCHIPPERKES 1-0-1D,0B-0NR  
11 SHIBA INU 1-6-3D,1B-0NR  
6 AM ESK DOG 1-0-2D,3B-0NR  
10:00AM  
6 POODLE (MIN) 1-5-0D,0B-0NR  
21 PORT WATER DOG 5-5-6D,5B-0NR  
11:00AM  
9 KEESHONDEN 0-4-3D,2B-0NR  
7 LHASA 2-4-1D,0B-0NR  
9 TIBETAN TERR 0-6-1D,2B-0NR  
LUNCH 12:00PM

12:45PM  
3 COTON DE TULEAR 0-0-3D,0B-0NR  
3 BICHON 1-0-1D,1B-0NR  
11 BOSTON TERR 5-4-0D,2B-0NR  
12 POODLE (STAND) 3-6-1D,2B-0NR

### RING 7 HORSE BARN

**JUDGE: Ms. Linda Robey**  
**—144 DOGS**  
8:00AM  
3 AKITA 0-3-0D,0B-0NR  
6 ROTT 1-2-1D,2B-0NR  
11 BOXER 3-5-2D,1B-0NR  
7 WEIM 2-1-2D,2B-0NR  
9:00AM  
3 WIRE VIZSLAS 1-1-0D,1B-0NR  
9 PNTR-GS 2-2-3D,2B-0NR  
9 WIRE PTG GRIFN 1-1-3D,4B-0NR  
10:00AM  
1 POINTER 0-1-0D,0B-0NR  
4 PNTR-GW 1-2-0D,1B-0NR  
3 SPINONE 0-1-2D,0B-0NR  
17 RET-FLAT 5-4-6D,2B-0NR  
LUNCH 11:00AM  
11:45AM  
2 SPAN-SUSSEX 0-1-0D,1B-0NR  
14 SPAN-FLD 5-6-2D,1B-0NR  
2 SPAN-CKR(ASCOB) 1-1-0D,0B-0NR  
3 SPAN-CKR(PARTI) 2-0-0D,1B-0NR  
5 SPAN-CKR(BLACK) 1-0-1D,3B-0NR  
12:45PM  
5 RET-NSDT 1-0-1D,3B-0NR  
40 RET-GOLD 13-23-4D,0B-0NR

### RING 8 M.A.T. EXHIBITOR HALL

**JUDGE: Ms. Susan Neidlinger**  
**—16 ENTRIES**  
12:00PM  
14 FRENCH BULLDOG SWEEPS  
2 FRENCH BULLDOG VET SWEEPS

### RING 8 M.A.T. EXHIBITOR HALL

**JUDGE: Mr. Jason Hoke**  
**—175 DOGS (ALSO IN RING 3)**  
1:30PM  
53 FRENCH BULLDOG 22-18-4D,7B-2NR

### RING 9 DRAFT HORSE BARN

**JUDGE: Ms. Jennifer Landers**  
**—44 ENTRIES**  
8:30AM  
29 SPAN-WEL SPR SWEEPS  
10 SPAN-WEL SPR VETERAN SWEEPS  
5 SPAN-WEL SPR ALTERED SWEEPS

### RING 9 DRAFT HORSE BARN

**JUDGE: Mrs. Debbie L. Melgreen**  
**—115 DOGS**  
10:30AM  
115 SPAN-WEL SPR 24-36-17D,19B-9NR  
LUNCH BREAK AT JUDGES DISCRETION

### RING 10

**JUDGE: Mr. Russell Hornfisher**  
**—63 ENTRIES**  
8:00AM  
4 UTILITY A (45-47)  
8:35AM  
14 UTILITY B (49-62)  
10:35AM  
1 PRF UTLTY (72)  
10:45AM  
1 GRAD OPEN (73)  
10:55AM  
17 OPEN B (28-44)

### AFTER NOON

4 OPEN A (24-27)  
1 PRFD OPEN (71)  
**PREFERRED NOVICE WALK THRU**  
2 PRFD NOVICE (69-70)  
**NOVICE WALK THRU**  
5 NOV. A (11-15)  
8 NOV. B (16-23)

### BEGINNER NOVICE A & B WALK THRU

1 BGNR NOVICE A (63)  
5 BGNR NOVICE B (64-68)  
LUNCH BREAK AT JUDGES DISCRETION  
RING 11

# JANESVILLE-BELOIT KENNEL CLUB

## SATURDAY, MAY 4, 2019

### JUDGE: Mrs. Bonnie Hornfisher

**—65 ENTRIES**  
8:00AM  
Rally Master Set-up & Walk Thru  
9 RALLY MASTER (68-76)  
8:45AM  
Rally Excellent B Set-up & Walk Thru  
2 RALLY EXCELLENT A (58-59)  
8 RALLY EXCELLENT B (60-67)  
RING 11 CONT

9:30AM

Rally Advanced A & B Set-up & Walk Thru  
11 RALLY ADVANCED B (47-57)  
10:15AM  
Rally Intermediate Set-up & Walk Thru  
8 RALLY INTERMEDIATE (39-46)  
10:45AM  
Rally Novice A & B Set-up & Walk Thru  
9 RALLY NOVICE A (11-20)  
18 RALLY NOVICE B (21-38)

### VARIETY GROUPS

2:45PM

ORDER OF GROUP JUDGING UNLESS OTHERWISE ANNOUNCED BY 2:15PM

### VARIETY GROUP JUDGES

HOUDNGROUP ..... Dr. Edna K. Martin  
TOY GROUP ..... Mrs. Anne Katona  
TERRIERGROUP ..... Dr. Edna K. Martin  
HERDINGGROUP ..... Mrs. Sulie Greendale-Paveza  
NON-SPORTING GROUP ..... Mrs. Anne Katona  
WORKING GROUP ..... Mr. Richard Edwin Lake  
SPORTING GROUP ..... Ms. Linda Robey  
BEST IN SHOW ..... Mr. Jason Hoke

### AKC NATIONAL OWNER-HANDLED GROUPS WILL START AT 3:30PM FOLLOWING EACH REGULAR GROUP

HOUND ..... Mrs. Sulie Greendale-Paveza  
TOY ..... Mr. Jason Hoke  
TERRIER ..... Mrs. Anne Katona  
HERDING ..... Ms. Linda Robey  
NON-SPORTING ..... Mr. Jason Hoke  
WORKING ..... Mr. Robert J. Shreve  
SPORTING ..... Mrs. Sulie Greendale-Paveza  
BEST IN SHOW ..... Dr. Edna K. Martin

### PHOTOGRAPHER

Booth Photography  
PO Box 308, Williamston, MI 48895 • 517-655-4081  
www.boothshowphoto.com  
(Only the Official Photographer may take win pictures.)

### RV PARKING INFORMATION

Reserved overnight parking: \$35.00 per night

(includes electrical and some have water)

Non-reserved overnight parking: \$40.00

Stand alone over night parking in designated areas: \$25.00  
(no utilities)

Any other vehicle plugged into electricity at any time will be charged the daily rate of \$35.00.

ALL RV'S ARE TO USE GATE 4

GATE OPENS THURSDAY, MAY 2, 2019

AT NOON (12 pm CDT)

Gate will close Thursday, Friday, and Saturday nights at 10 PM. No RV's will be parked after 10PM.

Those wishing to park together need to send the reservations in the same envelope.

Any handicapped parking requests must be indicated on the reservation form.

Reservation must be received by April 28, 2019.

Parking assignments will be forwarded via email or by enclosing a self-addressed/stamped envelope.

Sites will measure approximately 20' x 40'. Only RV and one registered tow vehicle per site will be allowed.

\*You may need to back into your site.

RV's may be assigned to a 50 amp service and should have the **Appropriate Electrical Adapters**.

There is a public RV dump on site - \$8.00 self pay.

## BADGER KENNEL CLUB/SUNDAY, MAY 5, 2019

There are 1178 Dogs entered in this show with a total of 1203 entries and 143 different breeds.

### RING 1 HORSE BARN

JUDGE: Mr. Wayne F. Harmon  
—150 DOGS

- 8:00AM  
2 CHIN SHAR-PEI 1-1-0D,0B-0NR  
7 BULLDOG 0-4-1D,2B-0NR  
3 \*AIRDLE TERR 0-2-1D,0B-0NR  
14 DALMATIAN 6-6-2D,0B-0NR  
9:00AM  
49 FRENCH BULLDOG 20-19-4D,6B-0NR  
11:00AM  
13 SHIBA INU 2-7-3D,1B-0NR  
LUNCH 11:30AM  
12:15PM  
2 SCHIPPERKES 1-0-1D,0B-0NR  
2 TIBETAN SPAN 0-0-2D,0B-0NR  
1 \*SHIH TZU 0-0-1D,0B-0NR  
3 BICHON 1-0-1D,1B-0NR  
4 \*JAPANESE CHIN 1-2-1D,0B-0NR  
3 COTON DE TULEAR 0-0-3D,0B-0NR  
3 \*HAVANESE 2-1-0D,0B-0NR  
9 TIBETAN TERR 0-6-1D,2B-0NR  
1:15PM  
9 KEESHONDEN 0-4-3D,2B-0NR  
2 \*KERRY BLUE TERR 0-0-2D,0B-0NR  
5 SOFT COAT WHTN 1-4-0D,0B-0NR  
3 MIN SCHNAUZER 2-1-0D,0B-0NR  
3 WEST HIGH WHT 2-0-1D,0B-0NR  
4 SCOTTI TERR 1-1-1D,1B-0NR  
9 \*BEDLGTN TERR 4-4-1D,0B-0NR

### RING 2 HORSE BARN

JUDGE: Mr. Richard Edwin Lake  
—159 DOGS

- 8:00AM  
2 STAFF BULL TERR 1-0-1D,0B-0NR  
12 AM STAFF TERR 5-4-2D,1B-0NR  
8:30AM  
1 BULL(COLR) TERR 1-0-0D,0B-0NR  
2 BULL(WHITE) TER 0-2-0D,0B-0NR  
2 MINI BULL TERR 0-0-1D,1B-0NR  
1 CESKY TERR 0-0-1D,0B-0NR  
5 AUSTR TERR 1-3-1D,0B-0NR  
1 NORWICH TERR 0-0-1D,0B-0NR  
2 FOX TER(WIRE) 1-0-0D,0B-0NR  
2 RAT TERR 2-0-0D,0B-0NR  
1 RUSSEL TERR 0-1-0D,0B-0NR  
4 BORDER TERR 0-1-2D,1B-0NR  
5 FOX TER(SMOOTH) 4-1-0D,0B-0NR  
9:30AM  
1 AFFENPINSCHERS 0-1-0D,0B-0NR  
1 BRUSS GRIF 0-0-1D,0B-0NR  
3 CHIHUA (LONG) 0-1-2D,0B-0NR  
5 ENG TOY SP-BLEN 1-2-1D,1B-0NR  
3 CHIHUA (SMOOTH) 0-2-1D,0B-0NR  
14 PUGS 3-8-3D,0B-0NR  
10:30AM  
3 POODLES (TOY) 1-2-0D,0B-0NR  
2 MALTESE 1-1-0D,0B-0NR  
1 SILKY TERR 0-0-0D,1B-0NR  
1 YORKSHIRE TERR 1-0-0D,0B-0NR  
7 PEKE 2-1-4D,0B-0NR  
10 TOY FOX TER 4-2-2D,2B-0NR  
LUNCH 11:30AM

### RING 2 CONT

- 12:15PM  
10 CHIN CREST 5-1-2D,2B-0NR  
16 PAP 4-6-5D,1B-0NR  
1:15PM  
13 POM 5-3-5D,0B-0NR  
29 CAV KC SPAN 8-13-8D,0B-0NR

### RING 3 HORSE BARN

JUDGE: Mrs. Anne Katona  
—170 DOGS (ALSO IN RING 8)

- 8:00AM  
1 GBGV 1-0-0D,0B-0NR  
1 OTTERHND 0-0-0D,1B-0NR  
2 IBIZAN 2-0-0D,0B-0NR  
3 SALUKI 0-1-1D,1B-0NR  
6 IR WOLF 3-3-0D,0B-0NR  
13 BORZ 3-6-2D,2B-0NR  
9:00AM  
3 BASENJIS 1-0-1D,1B-0NR  
3 NOR ELK 1-1-1D,0B-0NR  
43 RET-GOLD 15-23-4D,0B-0NR

### RING 3 HORSE BARN

JUDGE: Mrs. Mareth K. Kipp  
—80 ENTRIES

- 11:00AM  
40 RET-LAB 18-19-3D,0B-0NR  
12:30PM  
16 SPAN-FLD 5-6-4D,1B-0NR  
24 JUNIOR SHOWMANSHIP ENTRIES  
(4 NV JR, 3 NV INTR, 2 OP JR,  
10 OP INTR, 5 OP SR)

### RING 4 HORSE BARN

JUDGE: Mr. Robert J. Shreve  
—140 DOGS

- 8:00AM  
5 RET-CURL 1-3-1D,0B-0NR  
11 SET-GORD 4-3-3D,1B-0NR  
12 BRIT 1-6-5D,0B-0NR  
9:00AM  
1 GTR SWISS MTN 0-0-1D,0B-0NR  
3 ST BERN 1-2-0D,0B-0NR  
2 NEWF 1-0-1D,0B-0NR  
4 LEONBERGER 1-2-0D,1B-0NR  
6 ROTT 1-2-1D,2B-0NR  
10 SAMOYED 1-0-3D,6B-0NR  
10:00AM  
1 STD SCHNAUZER 0-0-1D,0B-0NR  
1 SPAN-CLUM 1-0-0D,0B-0NR  
2 SPAN-AMW 0-1-1D,0B-0NR  
11 SET-ENG 1-3-5D,1B-0NR  
12 RET-CHESS 3-7-1D,1B-0NR  
7 MASTIFF 2-2-2D,1B-0NR  
LUNCH 11:30AM

## BADGER KENNEL CLUB/SUNDAY, MAY 5, 2019

### RING 4 HORSE BARN

JUDGE: Ms. Karen Fitzpatrick  
—9 ENTRIES

- 11:30AM  
6 PORT WATER DOG SWEEPS  
3 PORT WATER DOG VETERAN SWEEPS

### RING 4 HORSE BARN

JUDGE: Mr. Robert J. Shreve  
—140 DOGS

- 12:15PM  
24 PORT WATER DOG 7-5-7D,5B-0NR  
1:15PM  
2 SET-IRW 0-0-1D,1B-0NR  
6 SIB HKY 1-2-2D,1B-0NR  
6 BELGIAN TERV 1-0-1D,4B-0NR  
7 SET-IRSH 1-3-2D,1B-0NR  
7 SPAN-ENG CKR 2-3-2D,0B-0NR

### RING 5 HORSE BARN

JUDGE: Mrs. Sulie Greendale-Paveza  
—151 DOGS

- 8:00AM  
14 ALAS MAL 2-5-4D,3B-0NR  
11 BOXER 3-5-2D,1B-0NR  
9:00AM  
1 POINTER 0-1-0D,0B-0NR  
7 PNTR-GS 1-1-3D,2B-0NR  
4 PNTR-GW 1-2-0D,1B-0NR  
3 SPINONE 0-1-2D,0B-0NR  
6 WEIM 2-1-2D,1B-0NR  
5 WIRE VIZSLAS 2-1-1D,1B-0NR  
10:00AM  
8 WIRE PTG GRIFN 1-1-3D,3B-0NR  
18 RET-FLAT 6-4-6D,2B-0NR  
11:00AM  
2 SPAN-SUSSEX 0-1-0D,1B-0NR  
2 SPAN-CKR(ASCOB) 1-1-0D,0B-0NR  
3 SPAN-CKR(PARTI) 2-0-0D,1B-0NR  
5 SPAN-CKR(BLACK) 1-0-1D,3B-0NR  
LUNCH 11:30AM  
12:15PM  
1 CANE CORSO 1-0-0D,0B-0NR  
3 GIANT SCHN 0-3-0D,0B-0NR  
5 RET-NSDT 1-0-1D,3B-0NR  
17 BULLMASTIFF 4-6-5D,2B-0NR  
1:30PM  
10 BERNS MNT DOG 3-6-0D,1B-0NR  
26 GRT DANE 9-8-4D,5B-0NR

### RING 6 HORSE BARN

JUDGE: Mr. Jason Hoke  
—169 DOGS

- 8:00AM  
44 VIZS 10-15-10D,9B-0NR  
9:45AM  
6 WHIP 2-2-1D,1B-0NR  
10 BASSET 4-2-3D,1B-0NR  
3 GREYHND 0-1-0D,2B-0NR  
8 SCOT DEER 2-3-1D,2B-0NR  
10:45AM  
1 AMER FOXHND 0-0-1D,0B-0NR  
5 AFGHAN 1-1-1D,2B-0NR  
1 REDBONE CHND 0-0-0D,1B-0NR  
14 RHO RIDGE 6-5-3D,0B-0NR  
6 DACH (LONGHAIR) 0-3-2D,1B-0NR  
LUNCH 11:45AM  
12:30PM  
13 POODLE (STAND) 3-7-1D,2B-0NR  
12 BOSTON TERR 6-4-0D,2B-0NR  
1:30PM  
6 AM ESK DOG 1-0-2D,3B-0NR  
7 LHASA 2-4-1D,0B-0NR  
5 LOWCHEN 2-2-1D,0B-0NR  
6 POODLE (MIN) 1-5-0D,0B-0NR  
6 DACH (SMOOTH) 0-3-3D,0B-0NR  
2 BEAGLE-15 INCH 0-0-2D,0B-0NR  
14 DACH (WIREHAIR) 3-5-5D,1B-0NR

### RING 7 HORSE BARN

JUDGE: Ms. Linda Robey  
—175 DOGS

- 8:00AM  
35 DOBE 12-15-4D,4B-0NR  
9:30AM  
2 AUST CATTLE DOG 2-0-0D,0B-0NR  
1 BELGIAN MAL 0-0-1D,0B-0NR  
5 BERGER PICARD 0-2-2D,1B-0NR  
6 COLLIE (SMOOTH) 3-2-0D,1B-0NR  
6 BORDER COLLIES 0-4-1D,1B-0NR  
2 BRIARD 0-1-0D,1B-0NR  
4 CANAAN DOGS 1-2-1D,0B-0NR  
10:30AM  
26 AUST SHEPHERD 5-14-6D,1B-0NR  
LUNCH 11:30AM  
12:15PM  
1 BELGIAN SHEEP 0-0-1D,0B-0NR  
24 COLLIE (ROUGH) 5-15-3D,1B-0NR  
1:15PM  
1 POL LOW SHP 0-0-1D,0B-0NR  
6 BEARDED COLLIE 1-3-2D,0B-0NR  
6 BOUVIER 0-3-1D,2B-0NR  
10 GERM SHEP DOG 5-4-0D,1B-0NR  
8 OLD ENG SHEEPDG 2-2-1D,3B-0NR  
2:30PM  
1 PULIK 0-0-1D,0B-0NR  
3 SWED VALLHUND 0-2-0D,1B-0NR  
5 PEMB WLSH CORGI 0-2-3D,0B-0NR  
6 CARD WLSH CORGI 3-1-1D,1B-0NR  
17 SHETLAND SHEP 6-8-2D,1B-0NR

### RING 8 DRAFT HORSE BARN

JUDGE: Mrs. Anne Katona  
—170 DOGS (ALSO IN RING 3)

- 11:45AM  
95 SPAN-WEL SPR 24-36-16D,18B-0NR

# BADGER KENNEL CLUB

SUNDAY, MAY 5, 2019

VARIETY GROUPS

3:15PM

ORDER OF GROUP JUDGING UNLESS OTHERWISE ANNOUNCED BY 2:15PM

## VARIETY GROUP JUDGES

NON-SPORTING GROUP .....	Mr. Wayne F. Harmon
TERRIER GROUP .....	Mr. Richard Edwin Lake
WORKING GROUP .....	Mrs. Sulie Greendale-Paveza
TOY GROUP .....	Mr. Jason Hoke
HERDING GROUP .....	Ms. Linda Robey
HOUND GROUP .....	Mrs. Sulie Greendale-Paveza
SPORTING GROUP .....	Mr. Robert J. Shreve
BEST IN SHOW .....	Mrs. Anne Katona

## AKC NATIONAL OWNER-HANDLED GROUPS WILL START AT 2:45PM

NON-SPORTING .....	Mr. Richard Edwin Lake
TERRIER .....	Mr. Wayne F. Harmon
WORKING .....	Mr. Richard Edwin Lake
TOY .....	Mr. Wayne F. Harmon
HERDING .....	Mrs. Sulie Greendale-Paveza
HOUND .....	Mr. Jason Hoke
SPORTING .....	Mr. Richard Edwin Lake
BEST IN SHOW .....	Mr. Robert J. Shreve

*"Dogs found in an unsafe environment, distress or harm's way (for example: left unattended on a grooming table in a noose not attached to a safety release clip; left in a vehicle without proper ventilation) will be removed to safety. Exposing a dog to an unsafe environment, distress or harm's way is considered mistreatment."*

## EXHIBITORS PLEASE NOTE

Exhibitors should follow their Veterinarians' recommendation to assure their dogs are free of internal and external parasites, any communicable diseases, and have appropriate vaccinations.

No dogs that are disqualified for aggression will be allowed to enter these Shows, nor be allowed to be on the grounds. In addition, no aggression reinstatement procedures will be performed at these Shows.

*The Badger Kennel Club/Janesville-Beloit Kennel Club retains all rights to photograph or videotape by any means, and televise or reproduce these events in any way, now and in the future.*



## RAFFLE

Janesville-Beloit Kennel Club  
Saturday, May 4, 2019

## RAFFLE

Badger Kennel Club ~ Sunday, May 5, 2019  
Raffle for Junior Showmanship Fund  
Prizes include a Large Lap Quilt w/ a Dog Design  
Listen for Announcement during the Show.



## ROUTES TO SHOW

FROM (IOWA & SOUTHWEST WISCONSIN)-US 12 East/US 18 East to US 18 East. Turn **Left** on US 18 East. US 18 East to N Jackson Ave. Turn **Left** on N Jackson Ave.

FROM SOUTH (INTERSTATE 1-90/I-39)-Hwy 26 North to new Hwy 26 Bypass. Take Exit Hwy 18 (Cambridge/Jefferson Exit). Turn **Right** on Hwy 18. Turn **Left** on N Jackson Ave.

FROM WEST/EAST (INTERSTATE 1-94)-I-94 West to Exit 267 (Hwy 26/Johnson Creek/Watertown Exit) Turn **Left** on Hwy 26 South to new Hwy 26 Bypass. Take Exit Business Hwy 26. Turn **Left** on Business Hwy 26. Take **Right** on W Puerer Street.

RV'S MUST ENTER AT GATE 4 - WATCH FOR SIGNS.

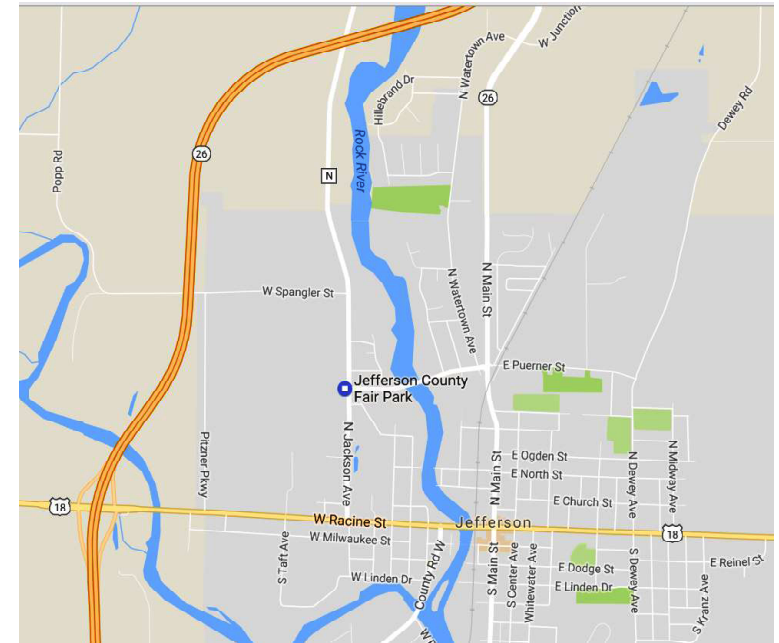

## ACCOMMODATIONS

**DO NOT ASSUME ACCEPTANCE OF DOGS, POLICIES CHANGE, YOU MUST CONFIRM THE MOTEL'S POLICY ON DOGS AND DAMAGE DEPOSITS.**

Hotel policies may change toward dogs, please verify current policies when making reservations.

### CLOSEST MOTELS

COURTYARD INN & SUITES ..... 1225 Janesville Ave., Fort Atkinson, WI 53538 • 920-563-6444  
RODEWAY INN ..... 1456 S Ryan Ave., Jefferson, WI 53549 • 920-674-4404 or 800-972-5530  
COMFORT SUITES- Johnson Creek ..... 725 Paradise Lane, Johnson Creek, WI 53038 • 920-699-2800  
DAYS INN MOTEL- Johnson Creek .. I-94 & 26, W 4545 Linmar Lane, Johnson Creek, WI 53038 • 920-699-8000

(approx. 8 miles from show site)

AMERICAS BEST VALUE INN - Lake Mills ..... West 7614 Oasis Lane, Lake Mills, WI 53551 • 920-648-3800  
HOLIDAY INN EXPRESS ..... 1780 Madison Ave., Fort Atkinson WI 53538 • 920-563-3600

### WATERTOWN AREA - 15-20 Minutes from Show Site

SUPER 8 WATERTOWN WI ..... 1730 S Church St., Watertown, WI 53094 • 920-261-1188  
HERITAGE INN HOTEL ..... 700 E Main St., Watertown, WI 53094 • 920-261-5700  
NITE-CAP MOTEL ..... 760 N Church St., Watertown, WI 53098 • 920-261-2452

### OFF OF BELTLINE - SOUTHEAST - 20-30 Minutes from Show Site

DAYS INN ..... 4402 E Broadway, Madison, WI 53716 • 608-223-1800  
AMERICINN (Small rooms) ..... 101 W Broadway, Monona, WI 53716 • 608-222-8601

### NEAR EAST TOWNE

RED ROOF INNS MADISON, WI ..... 4830 Hayes Road, Madison, WI 53704 • 608-241-1787  
RODEWAY INN & SUITES WI MADISON NORTHEAST ..... 4845 Hayes Rd., Madison, WI 53704 • 608-249-1815

### OCONOMOWOC

OLYMPIA RESORT & CONFERENCE CENTER 1350 Royale Mile Rd., Oconomowoc, WI 53066 • 800-558-9573 or 262-369-4999

### EAST SIDE OF MADISON ON HWY 12-18

MAGNUSON GRAND HOTEL ..... 3510 Mill Pond Road, Madison, WI 53718 • 608-224-1500

SLEEP INN & SUITES ..... 4802 Tradewinds Parkway, Madison WI 53718 • 608-221-8100



## ATTENTION EXHIBITORS PLEASE NOTE



The Clubs have instituted the following rules in the hopes of making things easier for everyone.

- Parking fees \$5.00 per day per car/van.
- Admission is Free to Spectators.
- Day Electric hook up \$35.00 per day.
- **UNLOADING INFORMATION** - please follow posted directions to facilitate an orderly flow in and out of unloading area:

**NO PARKING, UNLOADING OR LOADING IN THE FIRE LANES BETWEEN BUILDINGS. VIOLATORS WILL BE FINED AND VEHICLES TOWED.**

**ON THURSDAY:** -NO ADMITTANCE OF VEHICLES OR PEOPLE UNTIL 2:00 P.M. REGARDING SET-UP OF EQUIPMENT. *"The Clubs reserve the right to have exhibitors move or rearrange equipment as required to conserve space when requested by the show committee".*

- *Non-reserved indoor grooming space is limited to the Cleary building. Admittance to this building will be at 2:00 PM. There will be NO saving of space with cones, tape, electrical cords, etc. All equipment must be present and set up. The warm-up arena is also available for grooming.*

- EXHIBITORS WITH MULTIPLE ENTRIES MUST STACK ALL DOG CRATES, except for Giant breeds, and **COLLAPSIBLE/SOFT MESH CRATES ALLOWED ONLY AS SECOND STACKED CRATE &/or at Ringside.**
- NO MATS allowed anywhere in the building.
- Exhibitors are **EXPECTED** to KEEP THEIR GROOMING AREA CLEANED UP.
- Electricity is provided **AND IT IS EXPECTED THAT IT WILL BE SHARED.**
- The clubs reserve the right to determine use of electricity outlets.
- Private exercise pens during show hours must be set up only in **designated areas** during show hours and **must be kept clean & odor free throughout the show hours.** Those in non-designated areas must be taken down by 7:00 A.M. NO EXCEPTIONS. Show committee will determine what constitutes an ex-pen.
- **CRATES ALLOWED AT RINGSIDE** fifteen (15) minutes before Breed is judged, removal immediately after the Breed is judged will be enforced & crates removed.
- **NO SMOKING IN ANY BUILDING.**
- **NO SPACE PROVIDED FOR UNENTERED DOGS.**
- In order for the clubs to continue to use these facilities for further shows, we would appreciate your cooperation in leaving the grounds in the condition in which you found them.
- **NO STROLLERS WILL BE ALLOWED IN THE BUILDINGS.**
- Please turn off cell phones and/or pagers before entering rings.
- Only dogs entered in show are allowed on show grounds.

**PUBLICATION RIGHTS** By entering this show, all owners, handlers, breeders and kennels agree that all rights to televise, videotape, photograph, advertise, promote and publicize or otherwise exploit this show, or the persons or animals participating in it or the results of the competition before, during or after the event, shall belong solely to The American Kennel Club and their respective assigns, including the use of the names, likenesses or biographical matter of all dogs, owners, handlers, breeders and kennels participating in the show and no such owner, handler, breeder or kennel shall allow any other party to make commercial use of any videotape or photograph of any person or animal participating in this competition.

### ATTENTION OWNERS/EXHIBITORS OF FOREIGN REGISTERED DOGS

If you are the owner/exhibitor of a dog registered with a foreign registry (not yet dual registered with AKC) please review the eligibility requirements in The Rules Applying to Dog Shows, chapter 11 section 1. The dog show rules are posted on the AKC Web site at <http://images.akc.org/pdf/rulebooks/RREGS3.pdf>.

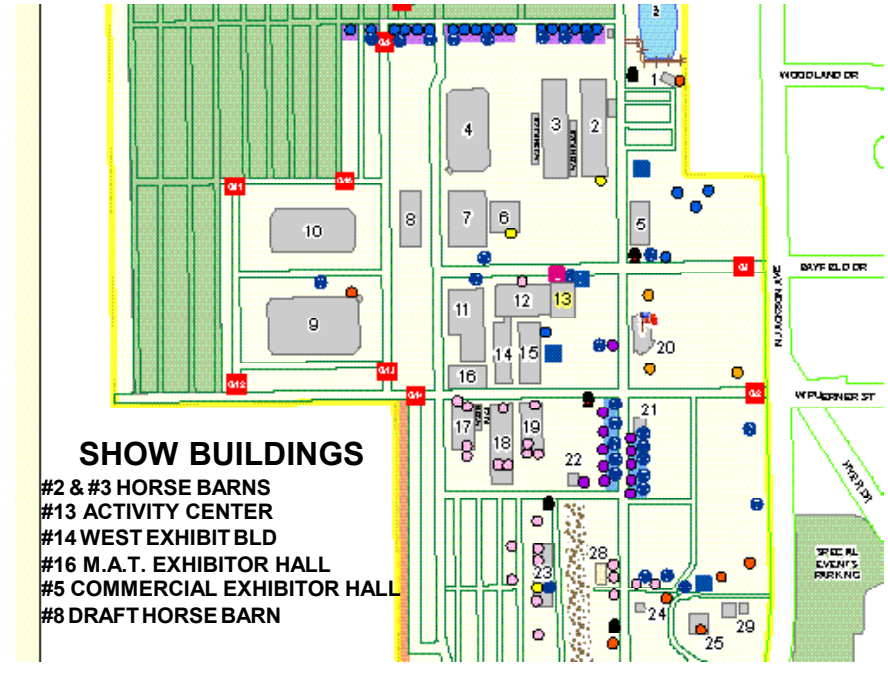

### Alphabetical Index to Breeds DAIRYLAND CLASSIC

BREED	FRIDAY		SATURDAY		SUNDAY	
	RING	TIME	RING	TIME	RING	TIME
AFFENPINSCHERS	04	10:45AM	03	9:00AM	02	9:30AM
AFGHAN	02	12:30PM	02	10:00AM	06	10:45AM
AIRDLE TERR	04	8:00AM	01	11:15AM	01	8:00AM
AKITA			07	8:00AM		
ALAS MAL	05	12:30PM	01	8:00AM	05	8:00AM
AM ESK DOG	06	8:00AM	06	9:00AM	06	1:30PM
AM STAFF TERR	04	1:30PM	01	11:15AM	02	8:00AM
AMER FOXHND	02	8:45AM	02	9:00AM	06	10:45AM
AUST CATTLE DOG			04	8:45AM	07	9:30AM
AUST SHEPHERD	02	9:45AM	04	9:45AM	07	10:30AM
AUSTR TERR	04	9:45AM	01	1:00PM	02	8:30AM
BASENJIS	02	1:45PM	02	12:15PM	03	9:00AM
BASSET	02	10:45AM	02	8:00AM	06	9:45AM
BEAGLE-15INCH	02	1:45PM	02	12:15PM	06	1:30PM
BEARDED COLLIE	02	12:30PM	04	12:45PM	07	1:15PM
BEDLGTN TERR	04	10:45AM	01	1:00PM	01	1:15PM
BELGIAN MAL					07	9:30AM
BELGIAN SHEEP					07	12:15PM
BELGIAN TERV	01	12:15PM	04	8:45AM	04	1:15PM
BERGER PICARD	02	9:45AM	04	8:45AM	07	9:30AM
BERNS MNT DOG	05	1:30PM	01	8:00AM	05	1:30PM
BGNR NOVICE A	08	1:30PM	10	1:00PM		
BGNR NOVICE B	08	1:30PM	10	1:00PM		
BICHON	06	1:45PM	06	12:45PM	01	12:15PM
BORDER COLLIES	02	8:45AM	04	8:45AM	07	9:30AM
BORDER TERR	04	8:00AM	01	1:00PM	02	8:30AM
BORZ	02	8:45AM	02	10:00AM	03	8:00AM
BOSTON TERR	06	1:45PM	06	12:45PM	06	12:30PM
BOUVIER	01	12:15PM	04	8:45AM	07	1:15PM
BOXER	05	8:00AM	07	8:00AM	05	8:00AM
BRIARD	02	9:45AM	04	8:45AM	07	9:30AM
BRIT	03	8:00AM	05	9:30AM	04	8:00AM

**PLEASE NOTE THE TIMES IN THIS INDEX ARE APPROXIMATE, PLEASE CHECK APPROPRIATE RINGS FOR EXACT TIME AND ORDER OF JUDGING**

**Alphabetical Index to Breeds**

**DAIRYLAND CLASSIC**

BREED	FRIDAY		SATURDAY		SUNDAY	
	RING	TIME	RING	TIME	RING	TIME
BRUSS GRIF	04	9:45AM	03	9:00AM	02	9:30AM
BULL(COLR) TERR	04	8:00AM	01	11:15AM	02	8:30AM
BULL(WHITE) TER	04	8:00AM	01	11:15AM	02	8:30AM
BULLDOG	02	10:45AM	06	8:00AM	01	8:00AM
BULLMASTIFF	05	8:30AM	01	10:30AM	05	12:15PM
CANAAN DOGS	02	9:45AM	04	8:00AM	07	9:30AM
CANE CORSO			01	8:00AM	05	12:15PM
CARD WLSH CORGI	01	1:15PM	04	12:45PM	07	2:30PM
CAV KC SPAN	04	12:30PM	03	11:00AM	02	1:15PM
CESKY TERR					02	8:30AM
CHIHUA (LONG)	04	9:45AM	03	10:00AM	02	9:30AM
CHIHUA (SMOOTH)	04	10:45AM	03	9:00AM	02	9:30AM
CHIN CREST	04	9:45AM	03	12:45PM	02	12:15PM
CHIN SHAR-PEI	06	11:00AM	06	8:00AM	01	8:00AM
COLLIE (ROUGH)	01	12:15PM	04	10:45AM	07	12:15PM
COLLIE (SMOOTH)	01	9:00AM	04	8:00AM	07	9:30AM
COTON DE TULEAR	06	1:45PM	06	12:45PM	01	12:15PM
DACH (LONGHAIR)	01	1:15PM	02	10:00AM	06	10:45AM
DACH (SMOOTH)	01	1:15PM	02	12:15PM	06	1:30PM
DACH (WIREHAIR)	01	1:15PM	02	12:15PM	06	1:30PM
DALMATIAN	02	12:30PM	06	8:00AM	01	8:00AM
DOBE	05	10:30AM	01	9:00AM	07	8:00AM
ENG TOY SP-BLEN	04	1:30PM	03	12:45PM	02	9:30AM
FOX TER(SMOOTH)	04	8:00AM	01	1:00PM	02	8:30AM
FOXTER(WIRE)	04	8:00AM	01	1:00PM	02	8:30AM
FRENCH BULLDOG	06	9:00AM	08	1:30PM	01	9:00AM
FRENCH BULLDOG SWEEPSTAKES			08	12:00PM		
FRENCH BULLDOG VET SWPS			08	12:00PM		
GBGV	02	10:45AM	02	8:00AM	03	8:00AM
GERM SHEP DOG	02	8:45AM	04	8:00AM	07	1:15PM
GIANT SCHN	05	2:30PM	01	11:15AM	05	12:15PM
GLEN OF IMAAL			01	1:00PM		
GRAD OPEN	08	10:25AM	10	10:45AM		
GREYHND	02	8:00AM	02	9:00AM	06	9:45AM
GRT DANE	05	9:30AM	03	8:00AM	05	1:30PM
GTR SWISSMTN	05	8:30AM	05	2:15PM	04	9:00AM
HAVANESE			03	12:45PM	01	12:15PM
IBIZAN			02	9:00AM	03	8:00AM
IR WOLF	02	8:45AM	02	9:00AM	03	8:00AM
IRISH TERR			01	11:15AM		
JAPANESE CHIN	04	1:30PM	03	11:00AM	01	12:15PM
JR SHOWMANSHIP	01	2:45PM	02	1:30PM	03	12:30PM
KEESHONDEN	02	10:45AM	06	11:00AM	01	1:15PM
KERRY BLUE TERR	04	1:30PM	01	11:15AM	01	1:15PM
LEONBERGER	05	8:00AM	05	2:15PM	04	9:00AM
LHASA	06	1:45PM	06	11:00AM	06	1:30PM
LOWCHEN	06	8:00AM	06	9:00AM	06	1:30PM
MALTESE	04	1:30PM	02	10:30AM		
MASTIFF	05	8:30AM	05	1:15PM	04	10:00AM
MIN SCHNAUZER	04	10:45AM	01	1:00PM	01	1:15PM
MINI BULL TERR					02	8:30AM
NEWF	05	2:30PM	05	2:15PM	04	9:00AM
NOR ELK	02	12:30PM	02	10:00AM	03	9:00AM
NORWICH TERR					02	8:30AM
NOV. A	08	1:30PM	10	1:00PM		
NOV. B	08	1:30PM	10	1:00PM		
OLD ENG SHEEPDG	02	12:30PM	04	12:45PM	07	1:15PM
OPEN A	08	1:30PM	10	1:00PM		
OPEN B	08	10:35AM	10	10:55AM		
OTTERHND	02	8:45AM	02	10:00AM	03	8:00AM
PAP	04	10:45AM	03	10:00AM	02	12:15PM
PEKE	04	10:45AM	03	10:00AM	02	10:30AM
PEMB WLSH CORGI	02	1:45PM	04	12:45PM	07	2:30PM
PNTR-GS	01	8:00AM	07	9:00AM	05	9:00AM
PNTR-GW	01	8:00AM	07	10:00AM	05	9:00AM
POINTER			07	10:00AM	05	9:00AM
POLLOW SHP	01	9:00AM	04	12:45PM	07	1:15PM

**PLEASE NOTE THE TIMES IN THIS INDEX ARE APPROXIMATE, PLEASE CHECK APPROPRIATE RINGS FOR EXACT TIME AND ORDER OF JUDGING**

**Alphabetical Index to Breeds**

**DAIRYLAND CLASSIC**

BREED	FRIDAY		SATURDAY		SUNDAY	
	RING	TIME	RING	TIME	RING	TIME
POM	04	1:30PM	03	11:00AM	02	1:15PM
POODLE (MIN)	02	1:45PM	06	10:00AM	06	1:30PM
POODLE (STAND)	06	1:45PM	06	12:45PM	06	12:30PM
POODLES (TOY)	02	1:45PM	03	12:45PM	02	10:30AM
PORT PD PEQ			02	12:15PM		
PORT WATER DOG	05	12:30PM	06	10:00AM	04	12:15PM
PORT WATER DOG SWEEPSTAKES					04	11:30AM
PORT WATER DOG VET SWPS					04	11:30AM
PRDF OPEN	08	1:30PM	10	1:00PM		
PRDF NOVICE	08	1:30PM	10	1:00PM		
PRDF UTILITY	08	10:15AM	10	10:35AM		
PUGS	06	8:00AM	03	9:00AM	02	9:30AM
PULIK	02	1:45PM	04	12:45PM	07	2:30PM
RAT TERR	04	8:00AM	01	1:00PM	02	8:30AM
REDBONE CHND	02	8:00AM	02	9:00AM	06	10:45AM
RET-CHESS	03	9:00AM	05	10:30AM	04	10:00AM
RET-CURL	03	9:00AM	05	9:30AM	04	8:00AM
RET-FLAT	01	9:00AM	07	10:00AM	05	10:00AM
RET-GOLD	06	12:15PM	07	12:45PM	03	9:00AM
RET-LAB	01	10:00AM	05	8:00AM	03	11:00AM
RET-NSDT	01	8:00AM	07	12:45PM	05	12:15PM
RHO RIDGE	02	8:00AM	02	8:00AM	06	10:45AM
ROTT	05	8:30AM	07	8:00AM	04	9:00AM
RUSSEL TERR			01	1:00PM	02	8:30AM
SALUKI	02	8:45AM	02	9:00AM	03	8:00AM
SAMOYED	05	1:30PM	05	2:15PM	04	9:00AM
SCHIPPERKES	02	1:45PM	06	9:00AM	01	12:15PM
SCOT DEER			02	9:00AM	06	9:45AM
SCOTTI TERR	05	2:30PM	01	1:00PM	01	1:15PM
SET-ENG	03	8:00AM	05	10:30AM	04	10:00AM
SET-GORD	03	8:00AM	05	9:30AM	04	8:00AM
SET-IRSH	03	9:00AM	05	1:15PM	04	1:15PM
SET-IRW	03	9:00AM	05	10:30AM	04	1:15PM
SHETLAND SHEP	01	1:15PM	04	12:45PM	07	2:30PM
SHIBAINU	06	8:00AM	06	9:00AM	01	11:00AM
SHIH TZU	04	12:30PM	03	12:45PM	01	12:15PM
SIB HKY	05	1:30PM	05	2:15PM	04	1:15PM
SILKY TERR	04	12:30PM	03	9:00AM	02	10:30AM
SOFT COAT WHTN	04	1:30PM	01	11:15AM	01	1:15PM
SPAN-AMW	03	9:00AM	05	12:15PM	04	10:00AM
SPAN-CKR(ASCOB)	06	1:45PM	07	11:45AM	05	11:00AM
SPAN-CKR(BLACK)	06	1:45PM	07	11:45AM	05	11:00AM
SPAN-CKR(PARTI)	06	1:45PM	07	11:45AM	05	11:00AM
SPAN-CLUM			05	12:15PM	04	10:00AM
SPAN-ENG CKR	03	9:00AM	03	1:15PM	04	1:15PM
SPAN-ENG SPR	05	2:30PM	05	12:15PM		
SPAN-FLD	06	11:00AM	07	11:45AM	03	12:30PM
SPAN-SUSSEX	01	9:00AM	07	11:45AM	05	11:00AM
SPAN-WEL SPR	07	10:45AM	09	10:30AM	08	11:45AM
SPAN-WEL SPR SWEEPSTAKES			09	8:30AM		
SPAN-WEL SPR VET SWPS			09	8:30AM		
SPINONE	01	8:00AM	07	10:00AM	05	9:00AM
ST BERN			05	2:15PM	04	9:00AM
STAFF BULL TERR					02	8:00AM
STD SCHNAUZER	05	8:30AM	05	12:15PM	04	10:00AM
SWED VALLHUND	02	1:45PM	04	12:45PM	07	2:30PM
TIBETAN SPAN	06	8:00AM	06	9:00AM	01	12:15PM
TIBETAN TERR	06	9:00AM	06	11:00AM	01	12:15PM
TOY FOX TER	04	9:45AM	03	9:00AM	02	10:30AM
UTILITY A	08	8:00AM	10	8:00AM		
UTILITY B	08	8:30AM	10	8:35AM		
VIZS	01	8:00AM			06	8:00AM
WEIM	01	8:00AM	07	8:00AM	05	9:00AM
WESTHIGH WHT	04	10:45AM	01	1:00PM	01	1:15PM
WHIP	02	10:45AM	02	8:00AM	06	9:45AM
WIRE PTG GRIFN	01	9:00AM	07	9:00AM	05	10:00AM
WIRE VIZSLAS			07	9:00AM	05	9:00AM
YORKSHIRE TERR	04	1:30PM			02	10:30AM

**PLEASE NOTE THE TIMES IN THIS INDEX ARE APPROXIMATE, PLEASE CHECK APPROPRIATE RINGS FOR EXACT TIME AND ORDER OF JUDGING**